

**Montering - Mounting
Montage - Montage**

80 mm min.

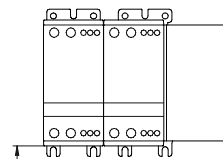
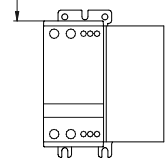

DK: Hvis enheden er monteret vandret, skal driftsstrømmen reduceres med 50%. Køleplade skal holdes ren. Luftstrømmen må ikke blokeres

UK: If the unit is mounted horizontally the current must be derated by 50%

DE: Falls Einheit horizontal montiert wird, muss der Strom um 50% reduziert werden

FR: En cas montage horizontal, réduire le courant de 50%

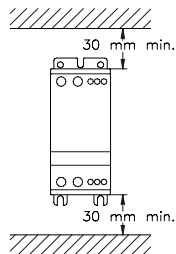

30 mm min.

30 mm min.

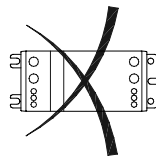
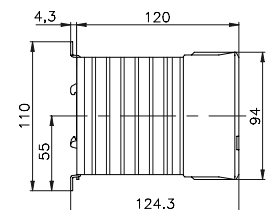
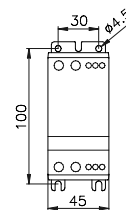
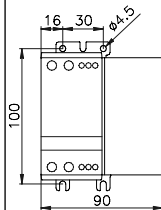
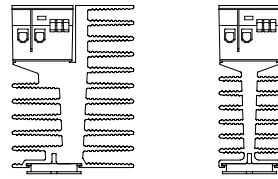
**Dimensioner - Dimensions
Dimensionen - Dimensions**

DK: Køleplade skal holdes ren. Luftstrømmen må ikke blokeres

UK: Keep heatsink clean. Airflow must not be blocked

DE: Kühlflächen freihalten. Luftstrom muss ungehindert fließen

FR: Maintenir les plaques de refroidissement libres, l'air doit pouvoir circuler



Forbindelse - Wiring - Verdrøtning - Cablage

75°C Cu Wire/Kabel	mm ²	mm ²
*	1 x 1.5 - 6	1 x 0.5 - 1.5
	2 x 1.5 - 6	2 x 0.5 - 0.75
*	1 x 1.5 - 6	1 x 0.5 - 1.5
	2 x 1.5 - 6	2 x 0.5 - 1.5
*	1 x 1 - 10	1 x 0.5 - 1.5
	2 x 1 - 6	2 x 0.5 - 1.5
Pozidrive 2	1.2 Nm max.	
	6 mm	3 mm
	1.2 Nm max.	0.4 Nm max.

* UL Tested

- **Vigtigt** (Overhold max skruedrejningsmomenter)
- **Important:** (Observe the maximum screw torque limits)
- **Wichtig:** (Max. Drehmoment beachten)

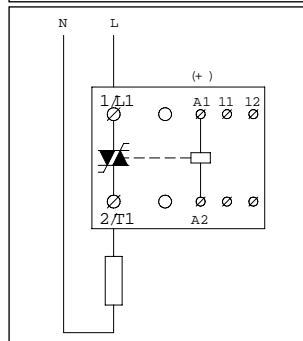
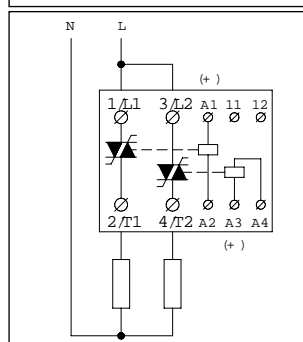
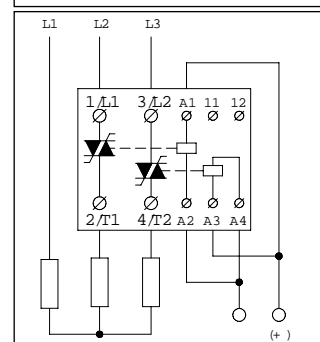
Do not connect power factor correction capacitors to the output.

SC 1 DX

SC 2 DX

SC 2 DX

UL: Use thermal overload protection as required by the National Electric Code.

UL: When protected by a non-time delay K5 or H Class fuse, rated 266 % of motor FLA, this device is rated for use on a circuit capable of delivering not more than 5,000 rms. symmetrical amperes, 600 V maximum. Maximum surrounding temperature 40°C.

DK: Se specifikationer i datablad

UK: See recommendation in datasheet

DE: Empfehlungen im Datenblatt beachten