

Symbolforklaring

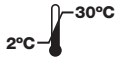

Opbevares ved 2-30 °C

EDTA CAPILLARY TUBES

EDTA-kapillarrør

CHASE BUFFER

Sporingsbuffer

Fuldblod

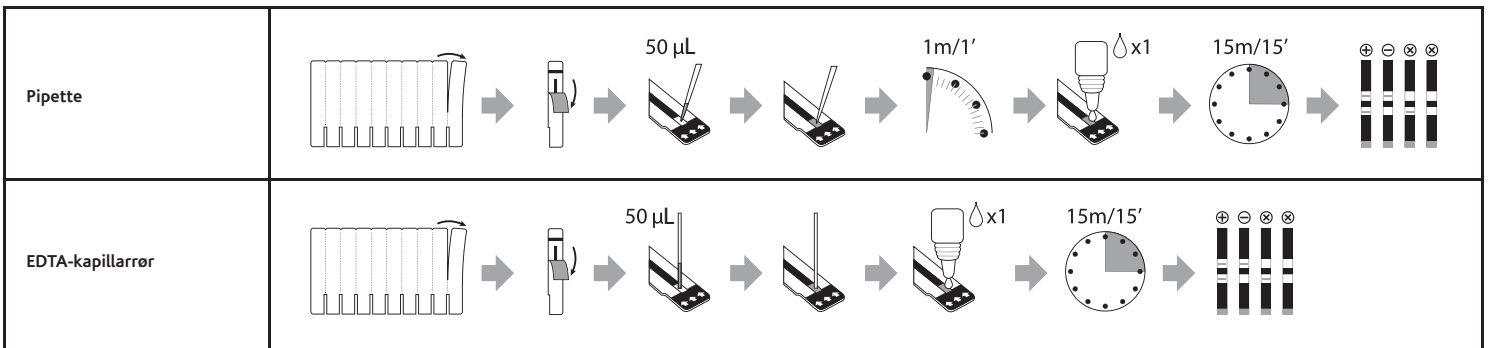

Serum, plasma

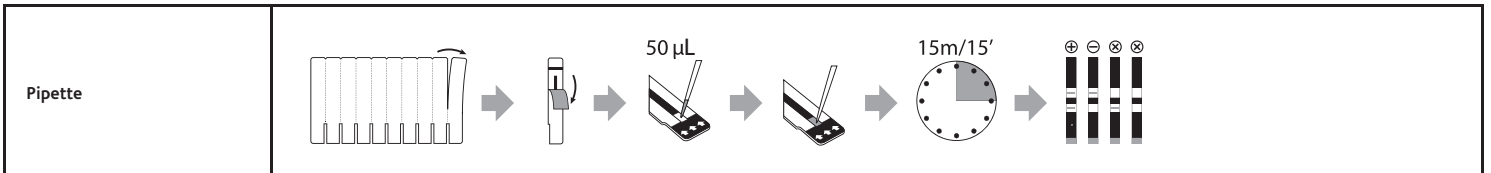

LITTERATURLISTE

- Plot P, Plummer FA, Mhalu FS, Lambarary JL, Chin J, Mann JM. AIDS: An International Perspective. *Science*. 1988;239:573-579.
- Weniger BG, Takebe Y, Ou CY, et al. The Molecular Epidemiology of HIV in Asia. *AIDS*. 1994;8(S2):S13-S28.
- Gürtler LG, Hauser PH, Eberle J, et al. A New Subtype of Human Immunodeficiency Virus Type 1 (MVP-5180) from Cameroon. *Journal of Virology*. 1994;68(3):1581-1585.
- Clinical and Laboratory Standards Institute. *Procedures and Devices for the Collection of Diagnostic Capillary Blood Specimens; Approved Standard-Fifth Edition H4-A5 Vol.24 No.21*
- Delaney KP, Branson BM, et al. Evaluation of the Performance Characteristics of 6 Rapid HIV Antibody Tests. *Clinical Infectious Diseases*. 2011; 52(2): 257-263.
- O'Connell RJ, Merritt TM, Malia JA, et al. Performance of the OraQuick Rapid Antibody Test for Diagnosis of Human Immunodeficiency Virus Type 1 Infection in Patients with Various Levels of Exposure to Highly Active Antiretroviral Therapy. *Journal of Clinical Microbiology*. 2003; 41(5):2153-2155.
- O'Connell RJ, Agan BK, Anderson SA, Malia JA, Michael NL. Sensitivity of the Multispot HIV-1/HIV-2 Rapid Test Using Samples from Human Immunodeficiency Virus Type 1-Positive Individuals with Various Levels of Exposure to Highly Active Antiretroviral Therapy. *Journal of Clinical Microbiology*. 2006; 44(6): 1831-1833.

Rådgivning

Kontakt din distributor, eller ring til et af de følgende Alere-supportcentre for yderligere oplysninger:

| Region | Telefon | E-mailadresse |
|--|---------------------|-------------------------------|
| Europa og Mellemøsten | + (44) 161 483 9032 | EMEproductsupport@alere.com |
| Asien og Stillehavsområdet | + (61) 7 3363 7711 | APproductsupport@alere.com |
| Afrika, Rusland og Fællesskabet af Uafhængige Stater | + (972) 8 9429 683 | ARCISproductsupport@alere.com |
| Latinamerika | + (57) 2 661 8797 | LAPproductsupport@alere.com |

