

# BETJENINGSVEJLEDNING



## FLÅMASKINE LIGHT OLIE/LUFT



Tlf. 7589 1244 \* Fax. 7589 1180

FLÅMASKINE \_\_\_\_\_ TYPE: \_\_\_\_\_

MASKIN NR.: \_\_\_\_\_ ÅR: \_\_\_\_\_

KUNDE: \_\_\_\_\_

FORHANDLER: \_\_\_\_\_

\_\_\_\_\_

\_\_\_\_\_

\_\_\_\_\_

Typeskilt

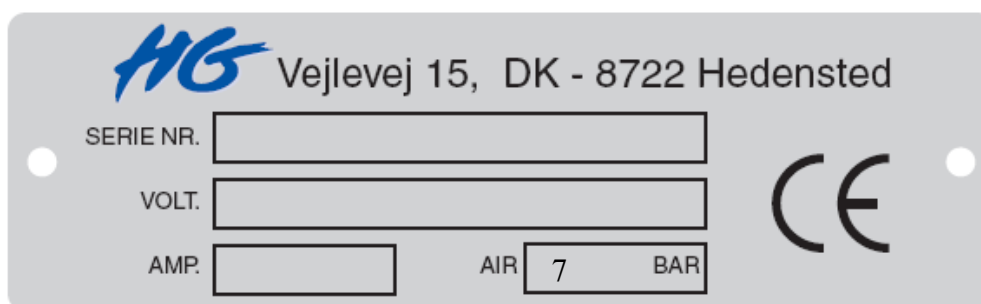

TYPE: 206400  
NO.: Løbenummer – produktionsår .  
VOLT:  
KW:  
AMP:  
DC:  
AIR: Arbejdstryk

# INDHOLDSFORTEGNELSE

|           |                                       |           |
|-----------|---------------------------------------|-----------|
| <b>1</b>  | <b>Advarsel</b>                       | <b>4</b>  |
| <b>2</b>  | <b>Montage</b>                        | <b>5</b>  |
| 2.1       | Opstilling                            | 5         |
| 2.2       | Tilslutning                           | 5         |
| <b>3</b>  | <b>Demontage</b>                      | <b>5</b>  |
| 3.1       | Flytning                              | 5         |
| <b>4</b>  | <b>Systembeskrivelse</b>              | <b>6</b>  |
| 4.1       | Introduktion                          | 6         |
| 4.2       | Opbygning                             | 6         |
| 4.3       | Funktion                              | 6         |
| 4.4       | Brugervejledning                      | 7         |
| <b>5</b>  | <b>Justering</b>                      | <b>8</b>  |
| 5.1       | Justering af Flåmaskinen              | 8         |
| 5.2       | Justering af kropskaster              | 9         |
| <b>6</b>  | <b>Vedligeholdelse / Rengøring</b>    | <b>9</b>  |
| 6.1       | Rengøring af Flåmaskinen              | 9         |
| <b>7</b>  | <b>Smøring</b>                        | <b>9</b>  |
| 7.1       | Smøring af Flåmaskinen.               | 9         |
| <b>8</b>  | <b>Afhjælpning af fejl</b>            | <b>10</b> |
| 8.1       | Fejlfinding – generelt                | 10        |
| <b>9</b>  | <b>Reservedelsliste</b>               | <b>11</b> |
| <b>10</b> | <b>Tekniske data</b>                  | <b>28</b> |
| <b>11</b> | <b>Luftdiagrammer</b>                 | <b>29</b> |
| 11.1      | Luftdiagram på Flåmaskine Light Olie. | 29        |
| <b>12</b> | <b>EU-overensstemmelseserklæring</b>  | <b>30</b> |

## 1 Advarsel

Læs denne betjeningsvejledning **grundigt** igennem inden ibrugtagelse.  
Undgå ophold for tæt på maskinen når luft tilkobles, da dens bevægelige dele kan reagerer med hurtige bevægelser.  
Flåmaskinen må kun anvendes til flåning af mink.  
Operatøren skal have instruktion til brug af maskinen

Vær opmærksom på følgende:

1. Pas på skarpe pigge.
2. Der er risiko for klemning af fingrene ved skindholderen
3. Der er risiko for perforering af arm eller hånd i gribe armene.
4. Hvis maskinen anvendes i nederste position (siddende) og cylinderen udstrækkes helt, kan skindholder støde mod jorden, herved er der risiko for at maskinen vælter.
5. Ved højdejustering skal der være to personer pga. maskinens vægt

Specielt vedrørende Flåmaskine Light Olie

6. Ved påfyldning af olie **skal** luft være frakoblet.
7. Maskinen må aldrig ligge ned.

## 2 Montage

### 2.1 Opstilling

Flåmaskinen placeres på gulvet.

Flåmaskinen kan justeres i højden, således at det er muligt at betjene maskinen både siddende og stående.

**Advarsel: Bemærk maskinens vægt**

Der mulighed for at flytte fodpedal i 2 positioner på beslaget, alt efter om maskinen betjenes siddende eller stående.

### 2.2 Tilslutning

Luft : Flåmaskinen kræver et kompressortryk på min. 7 bar, samt en lufttilførsel på min. 80 – 90 l/min. Luften skal være vandfri. Luften tilsluttes med en 1/2" sejnkobling.

**Advarsel: De bevægelige dele kan reagere ved lufttilslutning.  
For at undgå dette, skal fodpedalen stå i midterstilling.**

Luftslange må ikke ligge løs på gulvet, da der vil være risiko for Personskade.

For at undgå stop er det vigtig at luften, der bruges i Flåmaskinen er fri for vand og snavs, såsom rust fra gamle rør.

## 3 Demontage

### 3.1 Flytning

Ved flytning skal luft være frakoblet.

Bemærk maskinens vægt 60/70 kg.

## 4 Systembeskrivelse

### 4.1 Introduktion

Flåmaskinen kan anvendes til flåning af mink i alle pelserier.

Der ydes 1 års garanti på Flåmaskinen.

Defekte dele ombyttes, hvis fejlen kan henføres til fabrikationsfejl, dette gælder dog ikke fejl der kan henføres til fragt.

I tilfælde af fejlbetjening af Flåmaskinen, ydes der ingen garanti.

### 4.2 Opbygning

Flåmaskinen er fremstillet i overfladebehandlet stål. De enkelte komponenter er af højeste kvalitet, og dette kombineret med en overskuelig betjening gør, at De her står med en maskine af meget høj kvalitet.

Af funktionsmæssig årsag må maskinen (olie) aldrig ligge ned under transport.

### 4.3 Funktion

Flåmaskinen bruges efter minkens bagben er løsnet.

## 4.4 Brugervejledning

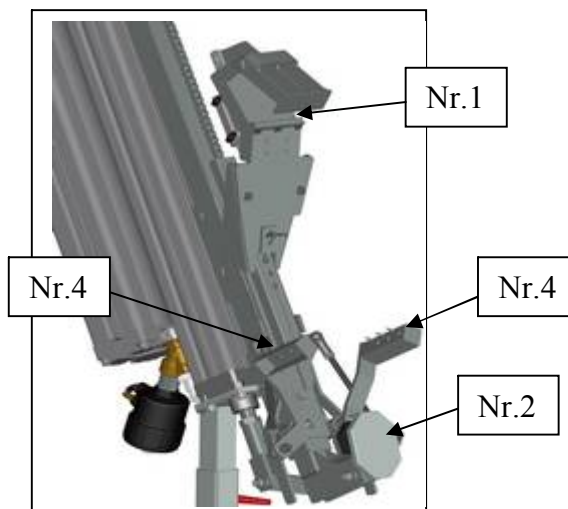

1. Efter bagkrop er løsnet placeres minken med bugsiden ind mod maskinen, og benene lægges i benklemmen (nr. 1).

**Advarsel:****Skarpe pigge**

2. Der tages fat i rygskindet (haleroden), som manuelt trækkes ned i åbningen på skindholderen (nr. 2).
3. Fodpedalen (nr. 3) aktiveres og flåningen påbegyndes.

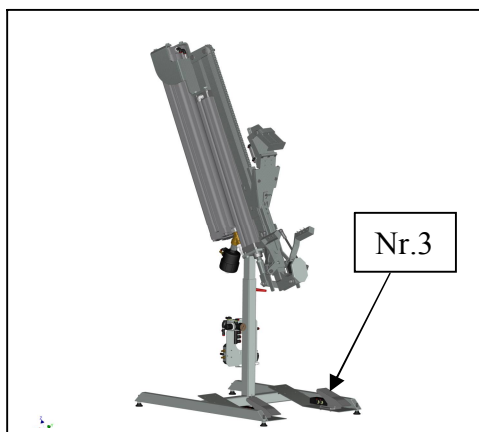
**Advarsel:****Risiko for klemning**

4. Når flåningen når dertil, hvor forbenene trækkes ud af skindet, skal gribe armene (nr. 4) manuelt køres i position ved hjælp af håndtaget på højre side af Flåmaskinen. Dette skal ske under flåningsprocessen, da man derved forhindrer at kroppen rives over.

**Advarsel:****Risiko for perforering af arm eller hånd.**

5. Processen fortsætter til hovedet, hvor flåningshastigheden bremses ved at slække på fodpedalen. Samtidig skærer man fri ved ørerne samt næse og mund.
6. Krop og skind fjernes, ved at man trykker på fodpedalens modsatte

side, så maskinen automatisk går tilbage i udgangsposition.

7. Et ny mink indsættes og flåning kan igen påbegyndes.

## 5 Justering

### 5.1 Justering af Flåmaskinen

Flåmaskinen kan indstilles til forskellige størrelser mink.

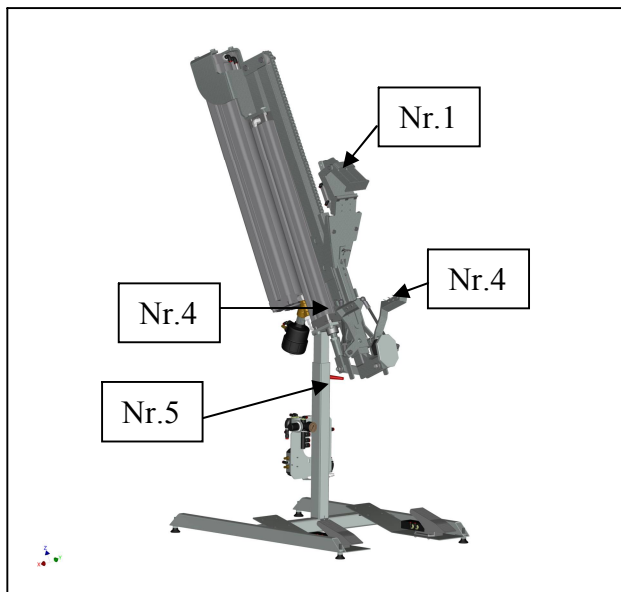

Justering af højde : Kiphåndtag (nr. 5) kan løsnes og maskinen indstilles efter ønske.

**Advarsel: Maskinens vægt 60/70 kg**

Justering af kropholder : Kan justeres efter minkens størrelse ved at løsne en 8mm fløj møtrik som er placeret på selve kropholderen (nr. 1)

Justering af gribearme : Fæstningsanordningen løsnes og Gribearmene (nr. 4) er justeret fra fabrik men kan justeres efter ønske.

Justering af fodpedal: De fire bolte løsnes og fodpedalen flyttes.



## 5.2 Justering af kropskaster

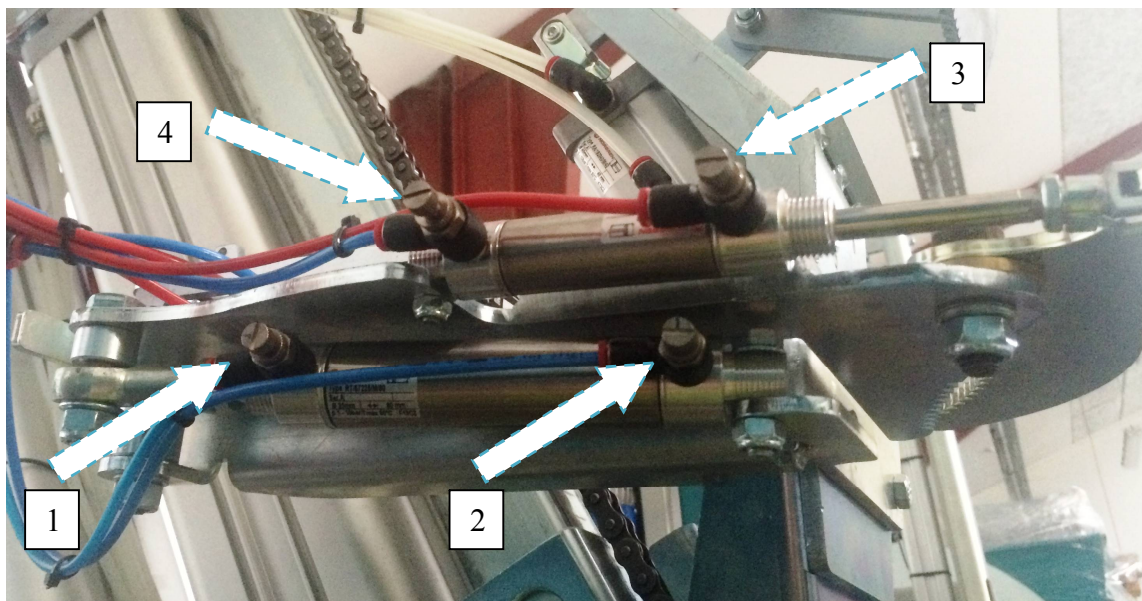

Kropskasterens hastighed justeres ved hjælp af drøvleventilerne på cylindererne, skruen på drøvleventilerne skrues ind for at bremse luften og ud for at åbne for luften.

1. Hvor hurtig armen skal svinge ud.
2. Hvor hurtig armen skal svinge ind.
3. Hvor hurtig kæben skal lukke.
4. Hvor hurtig kæben skal åbne.

## 6 Vedligeholdelse / Rengøring

### 6.1 Rengøring af Flåmaskinen

Maskinen rengøres dagligt med trykluft efter brug.

Rengøres en gang årligt med varmt sæbevand.

## 7 Smøring

### 7.1 Smøring af Flåmaskinen.

Alle bevægelige dele smøres 1 gang årligt med et tyndt lag olie eller fedt, gerne oftere.

## 8 Afhjælpning af fejl

### 8.1 Fejlfinding – generelt

Hvis maskinen ikke vil starte:

- Kontroller da lufttilslutningen.

Gælder kun Flåmaskine med olie.

Hvis der er kommet luft i strækcyllinderen.

- Maskinen køres et par gange frem og tilbage mellem de yderste positioner.

PARTS LIST

| ITEM | QTY   | PART NUMBER | DESCRIPTION                     |
|------|-------|-------------|---------------------------------|
| 1    | 9     | 10204030    | Bolt.unbraco cyl 4x30 FZB       |
| 2    | 2     | 10205025    | Bolt.unbrako cyl 5x25 FZB       |
| 3    | 2     | 11408025    | Hexagon bolt M8x25 FZB          |
| 4    | 8     | 17906000    | Self-locking nut M6 FZB         |
| 5    | 2     | 17908000    | Self-locking nut M8 FZB         |
| 6    | 1     | 205278      | Leg clamp assembly              |
| 7    | 1     | 206389      | Klampeventil 2                  |
| 8    | 1     | 206391      | Main valve                      |
| 9    | 1     | 206393      | Fodventil-Højre: 8mm ind-6mm ud |
| 10   | 1     | 206395      | Fodventil-Ventre 6mm            |
| 11   | 1     | 206397      | Klampeventil 1                  |
| 12   | 1     | 206398      | Clamp-chain assembly            |
| 13   | 1     | 215405      | Shutter valve G1/8              |
| 14   | 1     | 215535      | Panel mounting nut              |
| 15   | 1     | 215550      | Gauge 0-10 bar 1/8" Ø40         |
| 16   | 1     | 215765      | Swivel elbow Ø6mm 1/4"          |
| 17   | 1     | 215870      | Y-connector Ø8                  |
| 18   | 1     | 215925      | Straight connector Ø6mm 1/8"    |
| 19   | 15 m  | 216114      | Air hose Ø6mm pur white         |
| 20   | 4,5 m | 216120      | Air hose Ø8mm White             |
| 21   | 0,5 m | 216132      | Air hose Ø12mm pur white        |
| 22   | 1     | 216204      | Regulator 1/4" 0-10bar          |
| 23   | 2     | 216385      | Tee connector 6-1/8             |
| 24   | 1     | 216566      | 3x Swivel adaptor Ø6            |
| 25   | 1     | 30051       | Id plate Light oil 2012         |
| 26   | 1     | 31007       | Warning sign. Crushing          |
| 27   | 1     | 31030       | Support - service B 80xH 40mm   |
| 28   | 5 L   | 476740      | Hydraulic oil Q8 Hayden 10      |
| 29   | 2     | 7003208     | Pop rivet ø3.2x8mm              |
| 30   | 8     | 76006016    | Bolt buttonhead 6x16 FZB        |
| 31   | 4     | 82108000    | Washer M8 FZB                   |

D ( 1 : 2 )

A ( 0,26 : 1 )

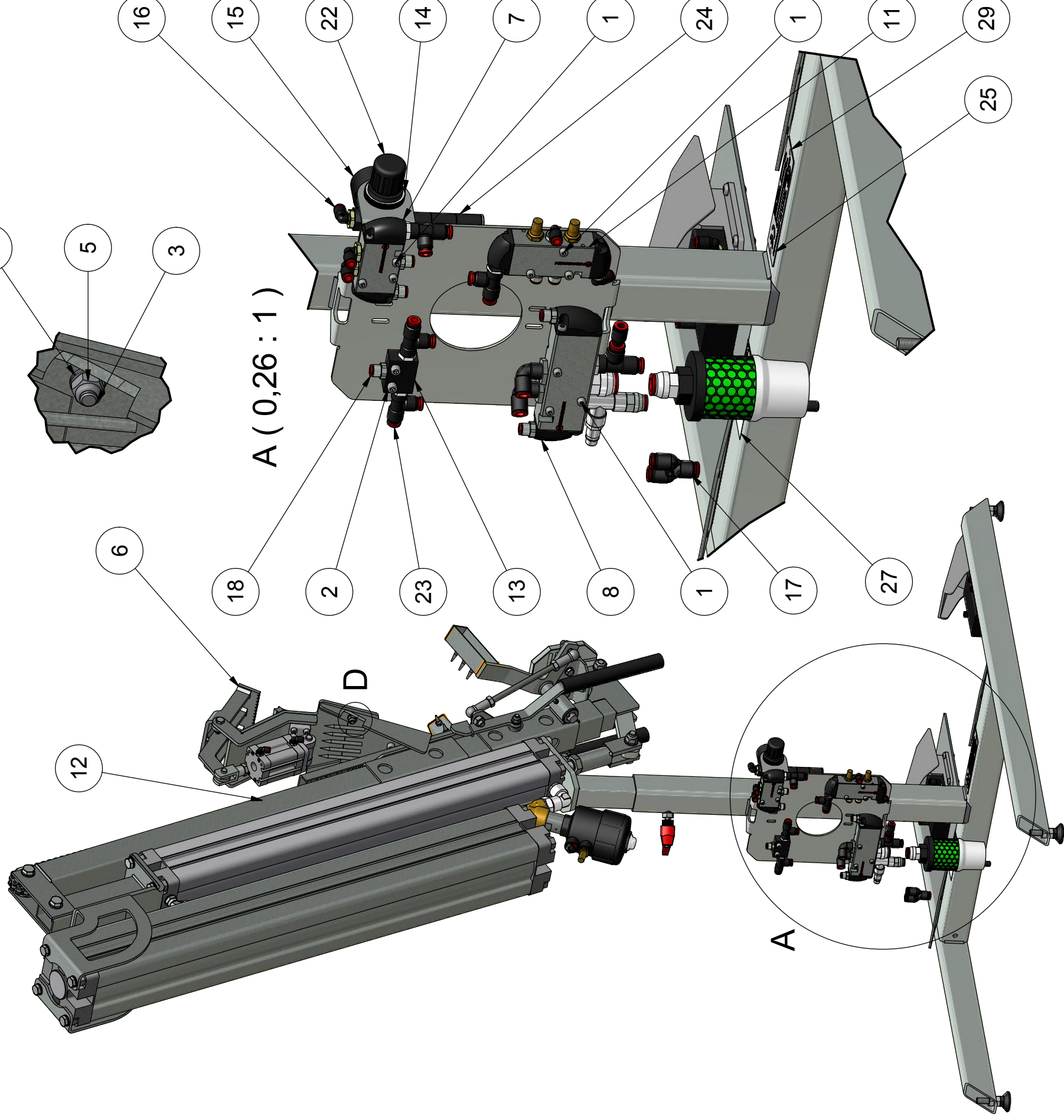

Alle kanter reifes  
Breake all edges

|              |                                |          |  |               |             |       |
|--------------|--------------------------------|----------|--|---------------|-------------|-------|
|              | Scale:                         | 0,13 : 1 | Ikke angivet tolerancer iht/ Not specified tolerance according to: | DS/ISO 2768-m | Sheet size: | A3    |
|              | Material:                      |          | Overfl. beskaffenhed/Surface properties:                           | No            | Sheet:      | 1 / 2 |
| Part No.:    | 206400                         |          |  |               |             |       |
| Description: | Skinningmachine light oil 2012 |          |  |               |             |       |
| Description: | Skinningmachine_light oil 2012 |          |  |               |             |       |

| REV | DESCRIPTION    | DATE       | APPROVED |
|-----|----------------|------------|----------|
| A   | New deawing    | 1-12-2011  | MRH      |
| B   | Fitting added  | 03-09-2012 | MRH      |
| C   | Stickers added | 25-02-2014 | MRH      |
| REV | DESCRIPTION    | DATE       | APPROVED |

REVISION HISTORY

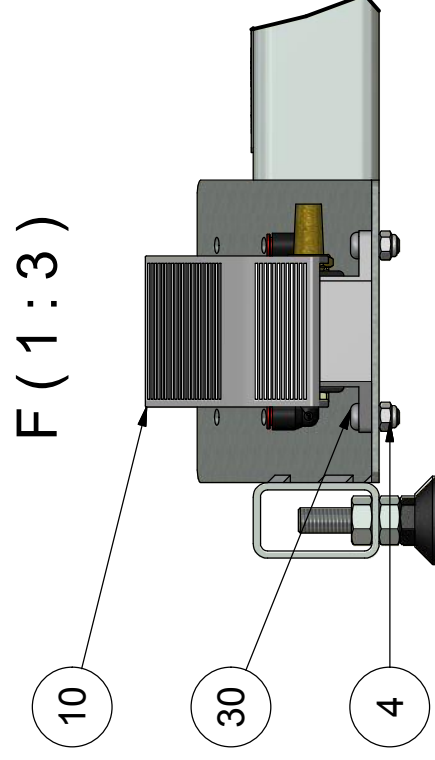
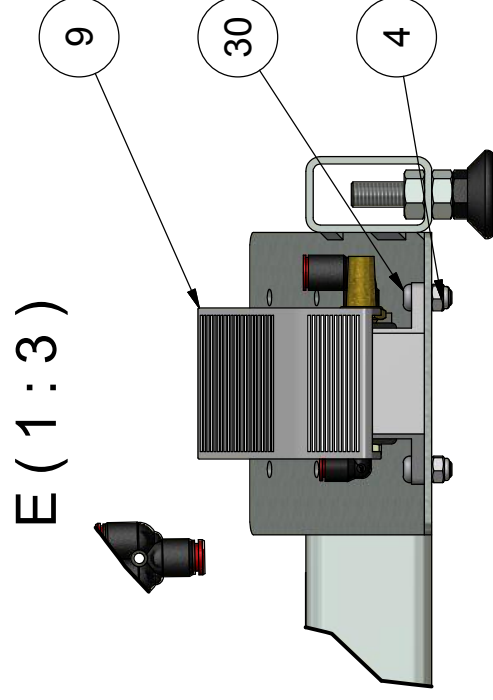
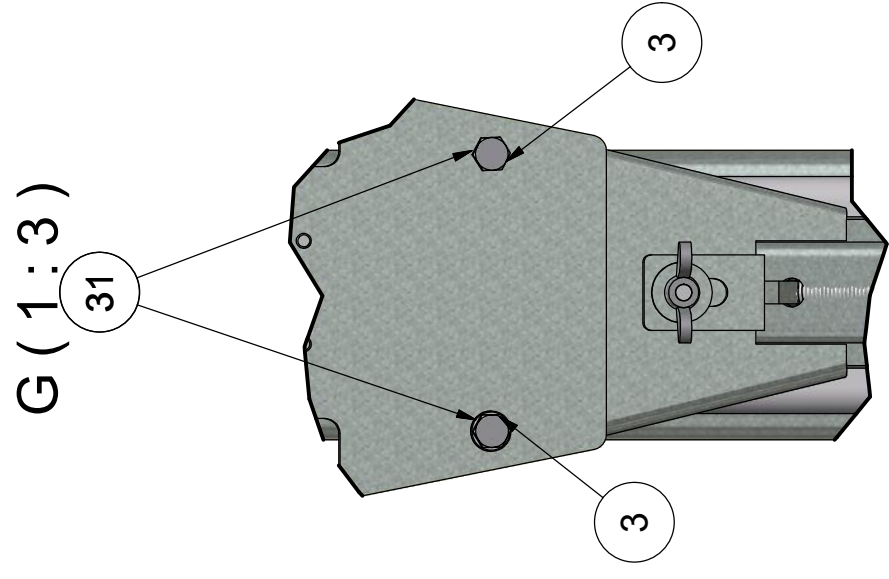
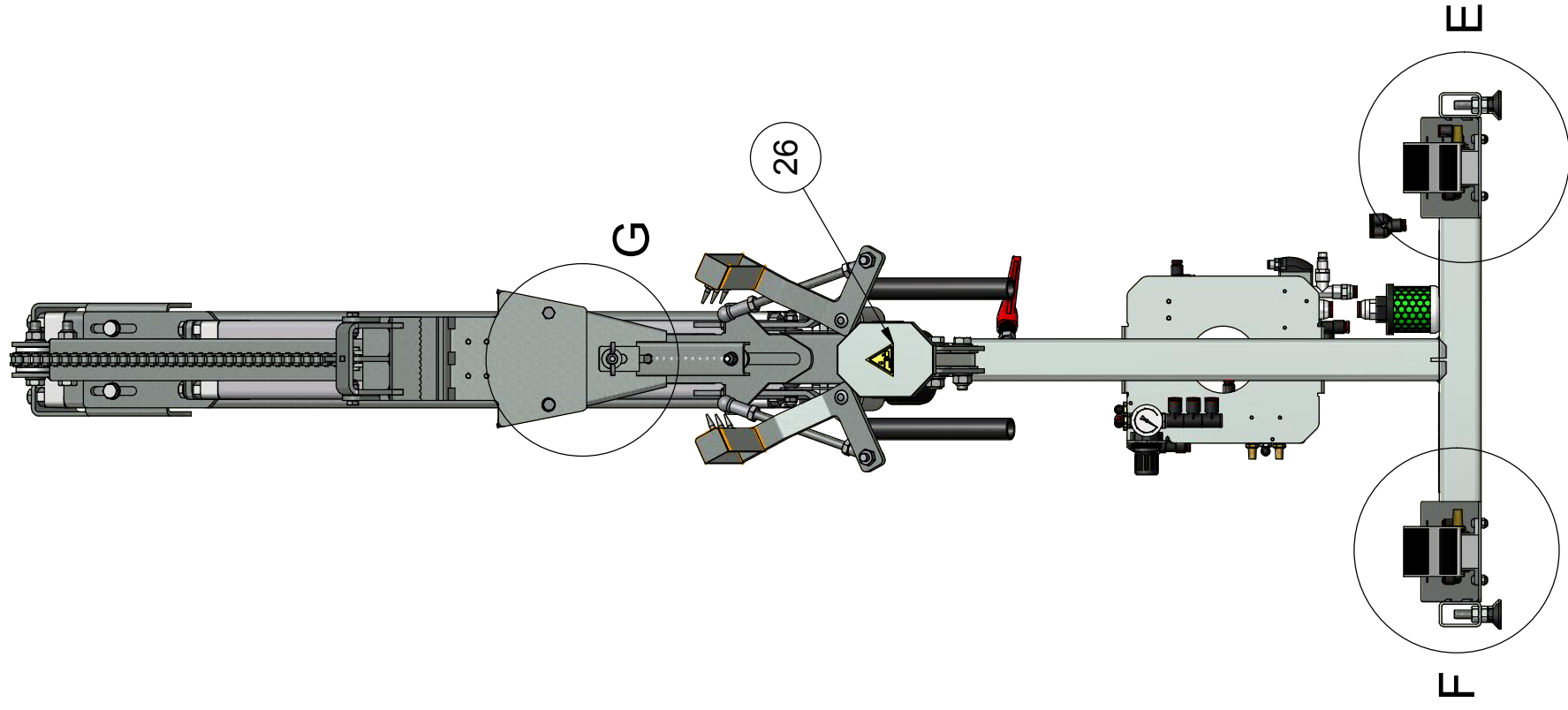

Alle kanter reifes  
Breake all edges



Scale: **0,13 : 1**  
 Ikke angivet tolerance iht/ Not specified tolerance according to: **DS/ISO 2768-m**  
 Overfil, beskaffenhed/Surface properties: **No**

Sheet size: **A3**

Sheet: **2 / 2**

Part No.: **206400**

Description: **Skinningsmachine light oil 2012**

Description: **Skinningsmachine\_light oil 2012**

This document is strictly confidential and must not be  
 account be copied or disclosed to any third person.  
 HEDENSTED GRUPPEN A/S



PARTS LIST

| ITEM | QTY    | PART NUMBER | DESCRIPTION                                    |
|------|--------|-------------|--|
| 1    | 2      | 11408012    | Hexagon bolt M8x12 FZB                         |
| 2    | 1      | 205285      | Bottom tube                                    |
| 3    | 1      | 205385      | Bodyclamp set                                  |
| 4    | 1      | 206396      | Stand assembly                                 |
| 5    | 1      | 206432      | Contact brace for tail clamp                   |
| 6    | 2      | 206436      | Plastic roll                                   |
| 7    | 0,98 m | 421361      | Roller chain 1/2 x 5/16                        |
| 8    | 2      | 421363      | Chain assembly 1/2" 5/16                       |
| 9    | 1      | 421364      | Chain assembly 1/2" (crip.)                    |
| 10   | 2      | 81212000    | Washer $\varnothing 13 \times 37 \times 3$ FZB |
| 11   | 2      | 82108000    | Washer M8 FZB                                  |
| 12   | 14     | 89309070    | Disc spring 18x9-2x0,7                         |

Pull chain through top tube and around chainwheel before mounting the chain to the bottom tube whit chain assembly link.

A (1 : 3)

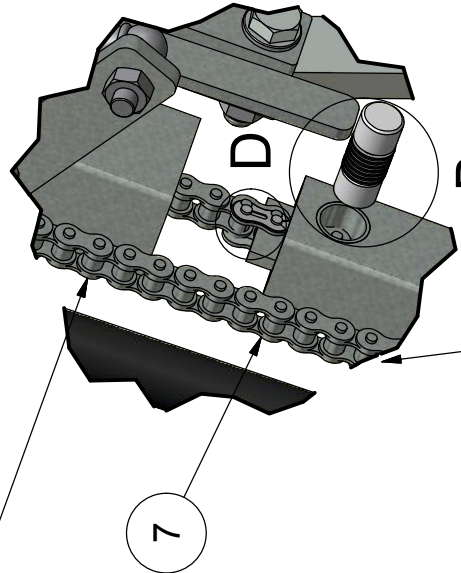

Add grease inside the top tube before sliding bottom tube in to place.

C (1 : 3)

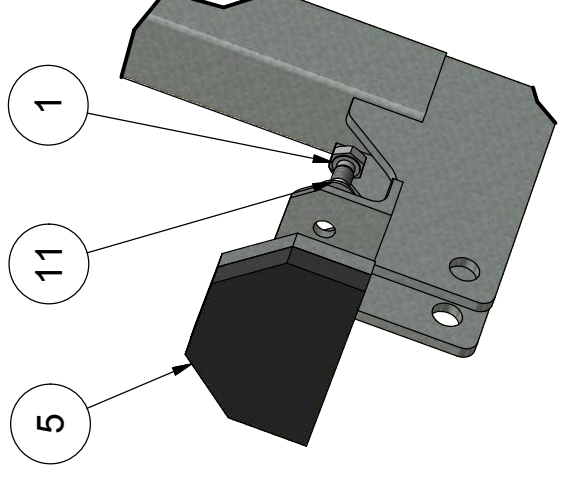

B (1 : 1)

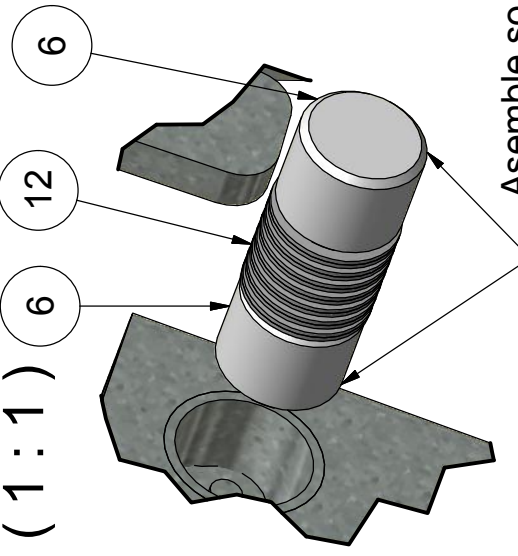

Assemble so length is 45mm, place spring washers face to face, and bottom to bottom.

D (1 : 1)

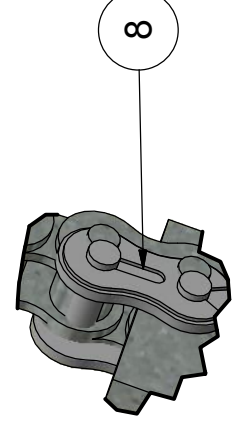

Alle kanter reifes  
Breake all edges

HEDENSTED GRUPPEN A/S  
This document is strictly confidential and must not be accounted copied or disclosed to any third person.

|                                |          |   |               |             |       |
|--------------------------------|----------|---|---------------|-------------|-------|
| Scale:                         | 0,12 : 1 | Like angivet tolerances (h/t) / Not specified tolerance according to: | DS/ISO 2768-m | Sheet size: | A3    |
| Material:                      |          | Overfl. beskaffenhed/Surface properties:                              | No            | Sheet:      | 1 / 2 |
| Part No.:                      | 206398   | Description:  |               |             |       |
| Description:                   |          | Clamp-chain assembly  |               |             |       |
| Revision:                      |          |   |               |             |       |
| Description:                   |          |   |               |             |       |
| Skinningmachine_light oil 2012 |          |   |               |             |       |

| REV | DESCRIPTION        | DATE       | APPROVED |
|-----|--------------------|------------|----------|
| A   | New drawing        | 06-12-2011 | MRH      |
| B   | Chain length added | 18-02-2014 | MRH      |
|     |                    |            |          |

REVISION HISTORY

F (1:1)

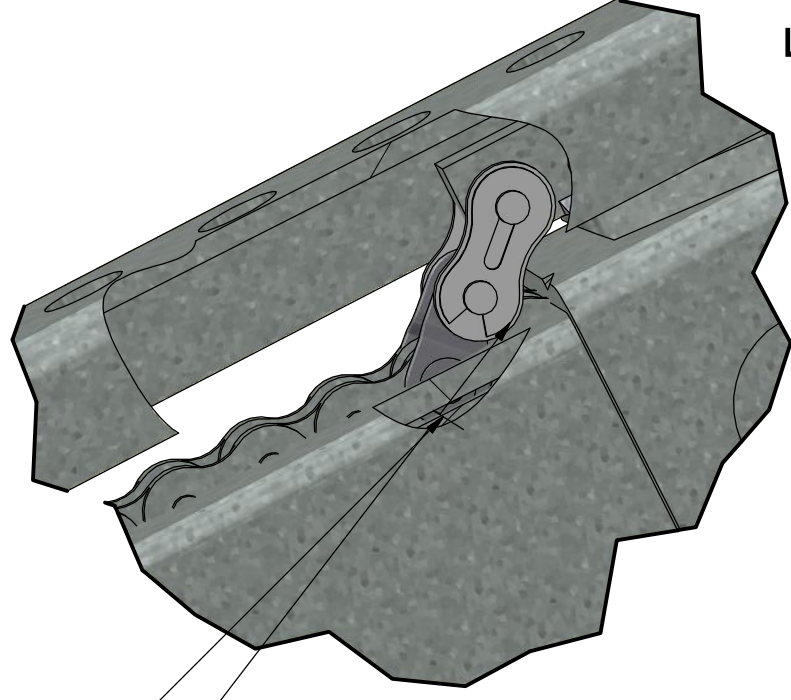

8  
9

E (1:2)

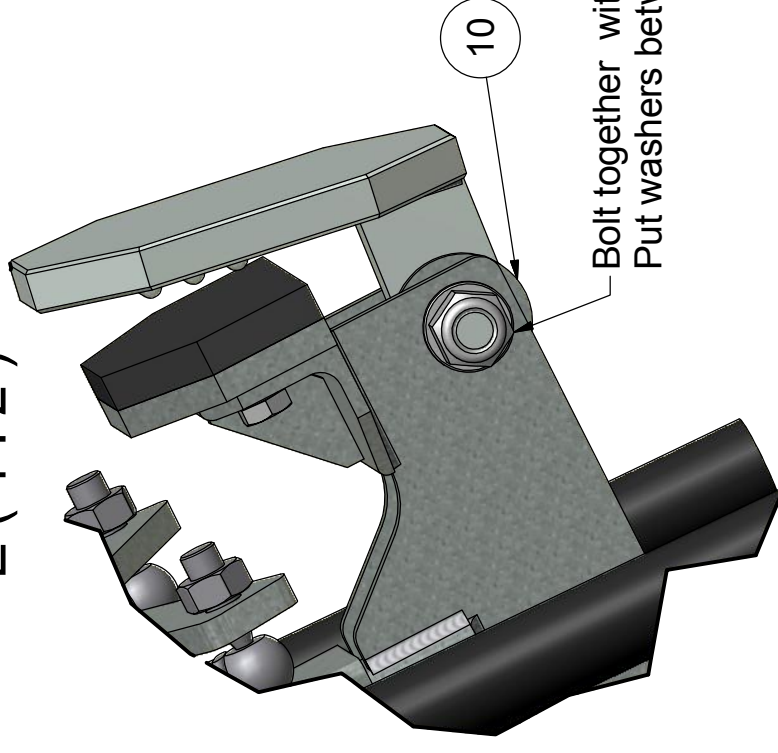

10

Bolt together with bottom tube.  
Put washers between arm and tube.

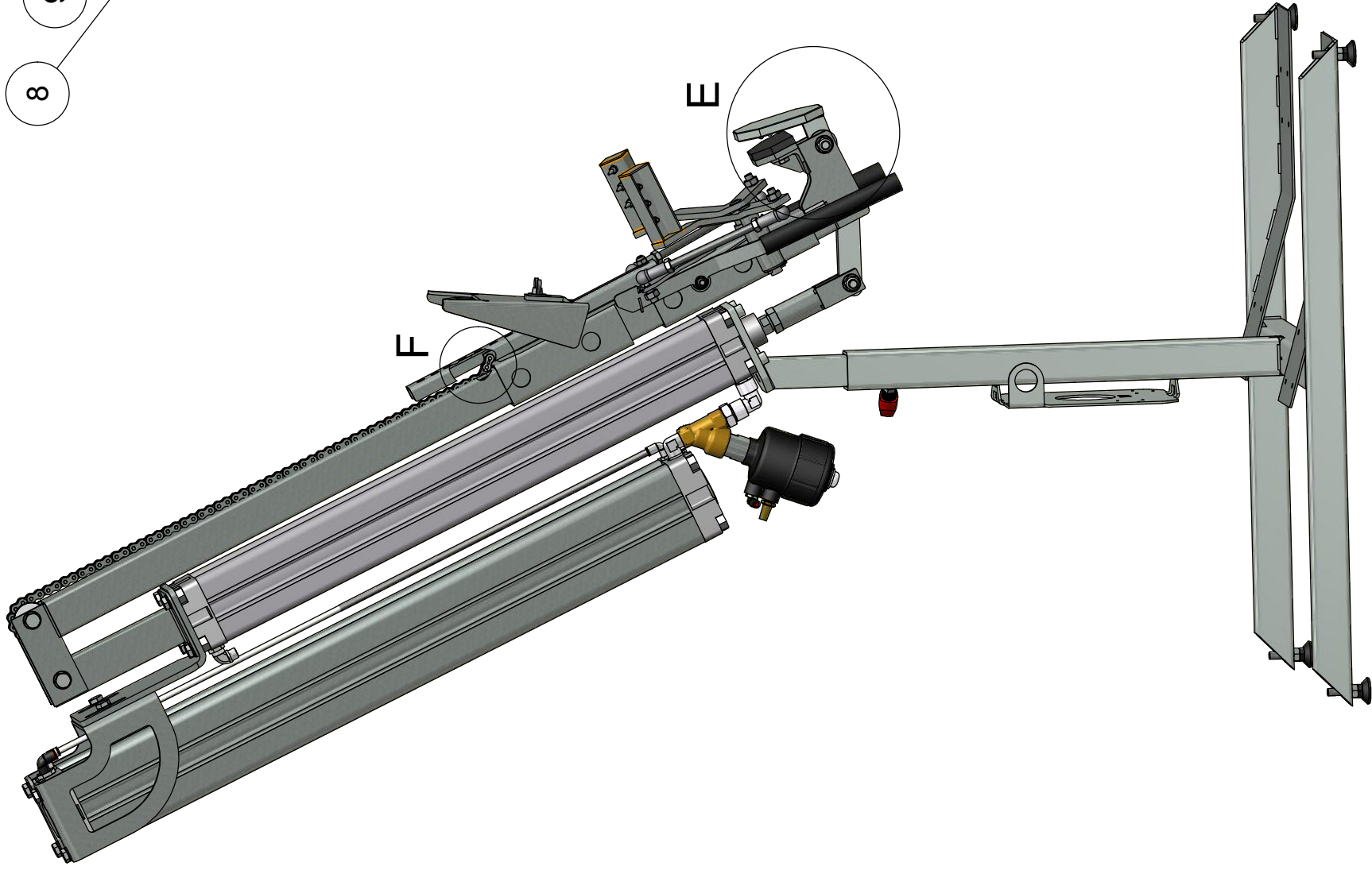

Alle kanter reifes  
Breake all edges

**HG**  
Hedensted  
Gruppen

HEDENSTED GRUPPEN A/S  
This document is strictly confidential and must not be  
account be copied or disclosed to any third person.

Scale: 0,12 : 1 Ikke angivet tolerancer iht/ Not specified tolerance according to:

DS/ISO 2768-m

Sheet size: A3

Overfil, beskaffenhed/Surface properties: No

Sheet: 2 / 2

Part No.: 206398

Material:

Description:

Clamp-chain assembly

Description:

Skinnermachine\_light oil 2012



PARTS LIST

| ITEM | QTY | PART NUMBER | DESCRIPTION                         |
|------|-----|-------------|-------------------------------------|
| 1    | 4   | 10210020    | Bolt unbraco cyl 10x20 FZB          |
| 2    | 2   | 11412055    | Hexagon bolt 12 x 55 FZB            |
| 3    | 2   | 11412070    | Hexagon bolt M12x70 FZB             |
| 4    | 4   | 17912000    | Self-locking nut M12 FZB            |
| 5    | 1   | 205365      | Top tube                            |
| 6    | 1   | 205427      | Fork for cylinder - oile light      |
| 7    | 1   | 205431      | Brace for tail clamp                |
| 8    | 1   | 205437      | Mount for cylinder                  |
| 9    | 1   | 205442      | Stand for skinning machine 2012     |
| 10   | 1   | 206390      | Cylinder assembly                   |
| 11   | 1   | 206434      | Chain wheel for skinning mashine    |
| 12   | 4   | 206468      | Adjusting screw Ø 37 mm, Foot       |
| 13   | 1   | 206485      | Elsa Quick release M10x25 nr 142211 |
| 14   | 8   | 82112000    | Washer M12 FZB                      |

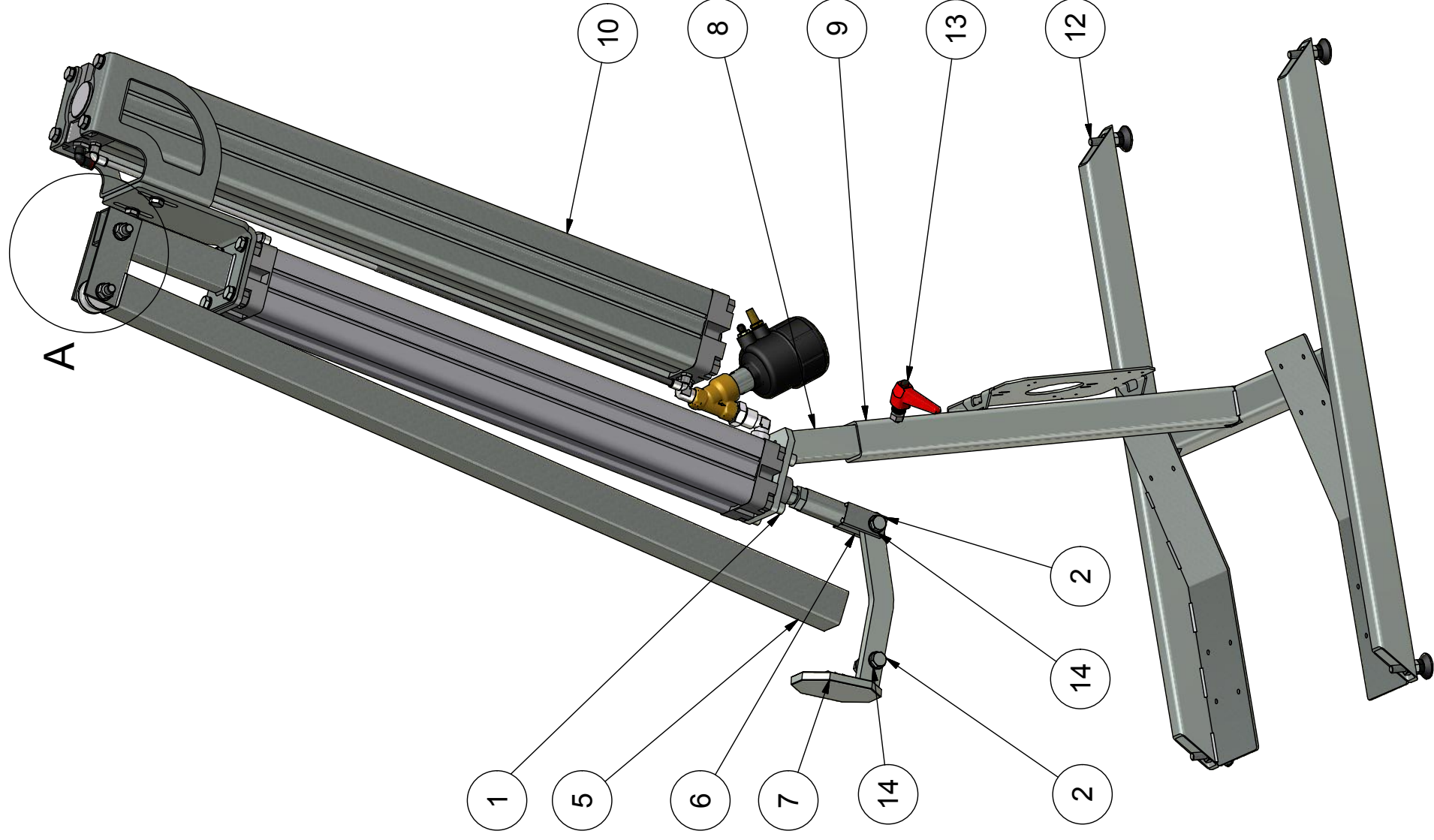

A (0,3 : 1)

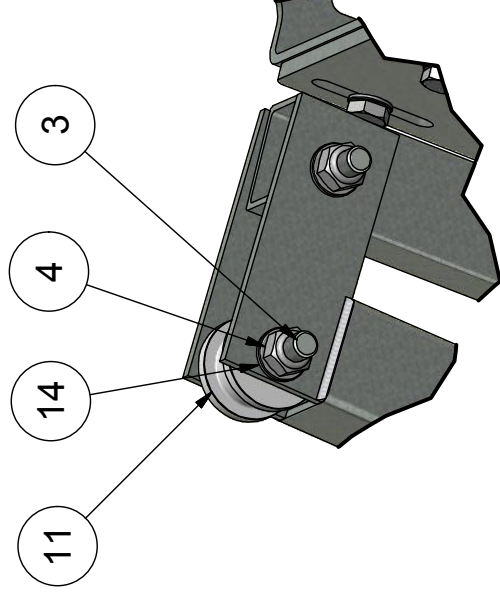

| REV | DESCRIPTION     | DATE       | APPROVED |
|-----|-----------------|------------|----------|
| A   | New drawing     | 06-12-2011 | MRH      |
| B   | Drawing opdatet | 20-08-2012 | MRH      |

REVISION HISTORY

Alle kanter reifes  
Breake all edges

|   |  |   |                                |
|---|--|---|--------------------------------|
|   |  | Scale: 0,13 : 1<br>Like angivet tolerance iht/ Not specified tolerance according to: DS/ISO 2768-m<br>Overfl. beskaffenhed/Surface properties: No | Sheet size: A3<br>Sheet: 1 / 2 |
| HEDENSTED GRUPPEN A/S<br><small>This document is strictly confidential and must not be copied or disclosed to any third person.</small> |  | Part No.: 206396<br>Description: Stand assembly   | Material:                      |
| Description: Skinning machine 2012  |  |   |                                |

PARTS LIST

| ITEM | QTY | PART NUMBER | DESCRIPTION                    |
|------|-----|-------------|--------------------------------|
| 1    | 6   | 11410020    | Hexagon bolt M10x20 FZB        |
| 2    | 4   | 11410030    | Hexagon bolt M10x30 FZB        |
| 3    | 1   | 205429      | Mount for cylinder             |
| 4    | 1   | 206392      | Cylinder mount                 |
| 5    | 1   | 206399      | Ø100 Cylinder Mount            |
| 6    | 1   | 206410      | Oil tank assembly              |
| 7    | 1   | 206438      | G1/2 Angle Seat Valve n RG 2/2 |
| 8    | 1   | 212085      | Cylinder HPSA/182080/700       |
| 9    | 1   | 215765      | Swivel elbow Ø6mm 1/4"         |
| 10   | 1   | 216295      | Flat union 1/2-1/2             |
| 11   | 1   | 216560      | Swivel elbow Ø8x3/8"           |
| 12   | 1   | 216579      | Elbow 2X female 1/2x1/2        |
| 13   | 1   | 216718      | Male nipple 1/2-3/8            |
| 14   | 1   | 216797      | Silencer 1/4" T40C-2800        |
| 15   | 10  | 82110000    | Washer M10 FZB                 |

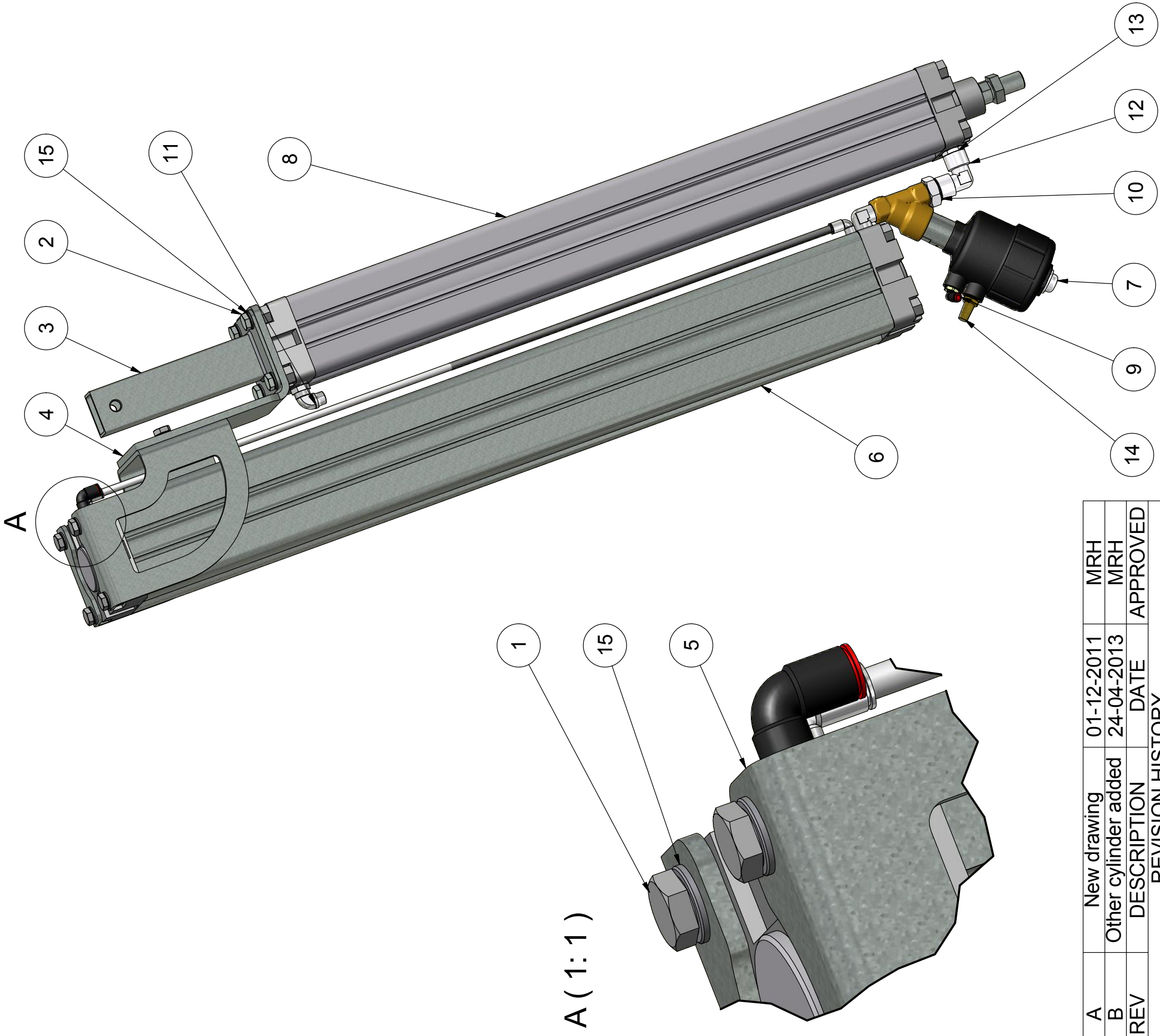

A (1:1)

| REV | DESCRIPTION          | DATE       | APPROVED |
|-----|----------------------|------------|----------|
| A   | New drawing          | 01-12-2011 | MRH      |
| B   | Other cylinder added | 24-04-2013 | MRH      |

REVISION HISTORY

Alle kanter reifes  
Breake all edges

**Hedensted Gruppen**  
 Part No.: 206390  
 Description: Cylinder assembly  
 Scale: 0,22 : 1  
 Material: No  
 DS/ISO 2768-m  
 Overfl. beskaffenhed/Surface properties: No  
 Sheet size: A3  
 Sheet: 1/1

This document is strictly confidential and must not be copied or disclosed to any third person.



PARTS LIST

| ITEM | QTY | PART NUMBER | DESCRIPTION         |
|------|-----|-------------|---------------------|
| 1    | 1   | 212105      | Oile tank PRA 7L    |
| 2    | 1   | 215774      | Swivel elbow Ø8-1/2 |
| 3    | 1   | 216580      | Elbow male 2X 1_2   |



| REV | DESCRIPTION | DATE       | APPROVED |
|-----|-------------|------------|----------|
| A   | Made        | 07-06-2012 | MRH      |
| B   | BOM changed | 24-08-2012 | KL       |

REVISION HISTORY

Alle kanter reifes  
Breake all edges

The document is strictly confidential and shall not be  
 account for copies or disclosure to any third party.  
 HEDESTED GRUPPEN A/S

|   |                   |             |       |
|---|-------------------|-------------|-------|
| Scale:                                  | 0,3 : 1           | Sheet size: | A3    |
| Verify. beaeflaemmetSurface properties: | No                | Sheet:      | 1 / 1 |
| Part No.:                               | 206410            |             |       |
| Part group:                             | Oil tank assembly |             |       |

PARTS LIST

| ITEM QTY | PART NUMBER | DESCRIPTION             |
|----------|-------------|-------------------------|
| 1 1      | 206460      | Footvalve SPDK/8032     |
| 2 2      | 216797      | Silencer 1/4" T40C-2800 |
| 3 3      | 215765      | Swirvel elbow Ø6mm 1/4" |
| 4 1      | 206464      | Spring for foot pedal   |

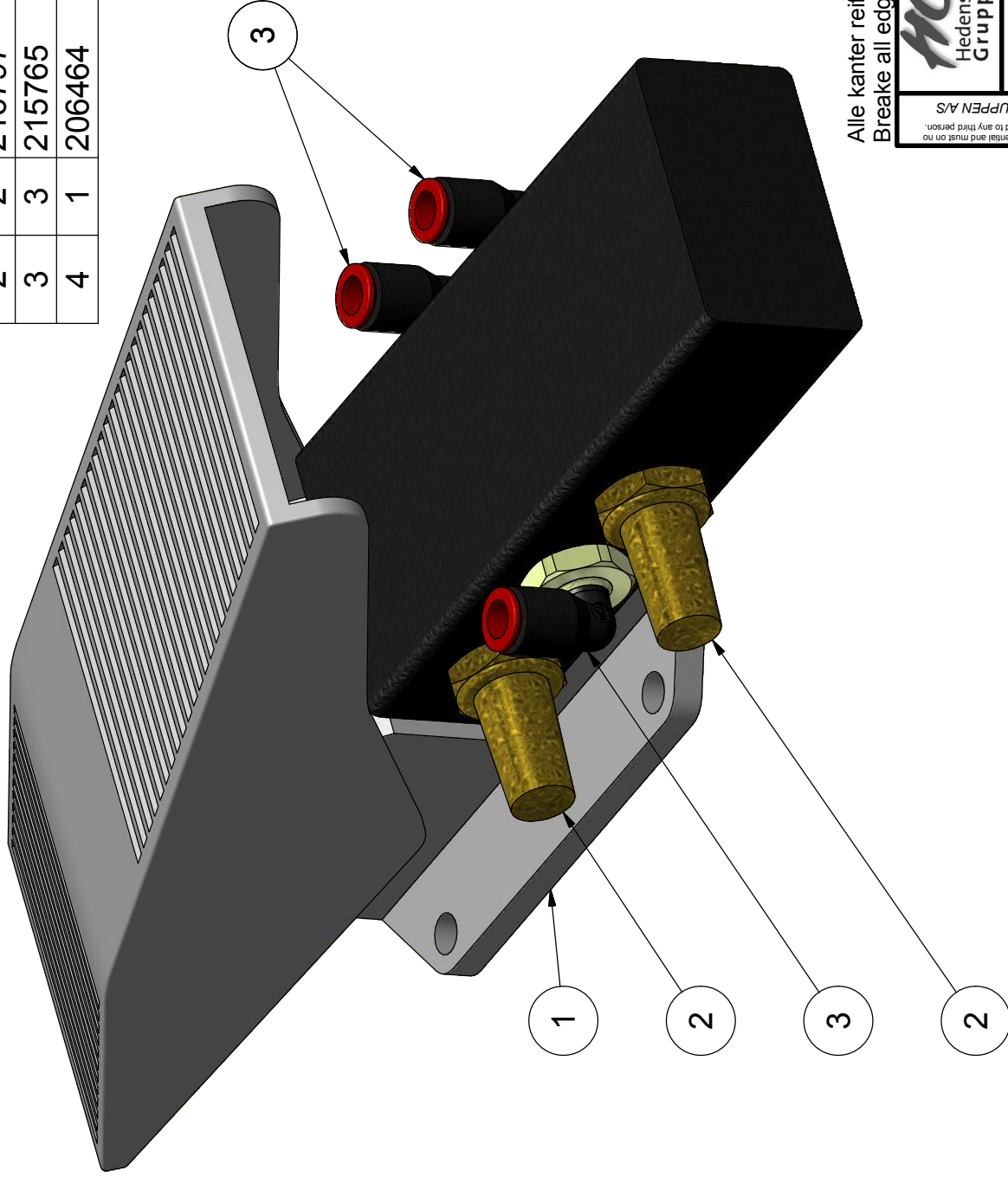

Alle kanter reifes  
Breake all edges



Part No.: 206395

Description:

Fodventil-Ventre 6mm

Description:

Scale: 1:1



Material:

Ikke angivet tolerancer iht./ Not specified tolerance according to:

DS/ISO 2768-m

Overfl. beskaffenhed/Surface properties:

No

Sheet size:

A4

Sheet:

1 / 1

This document is strictly confidential and must not be accounted for, copied or disclosed to any third person.  
HEDENSTED GRUPPEN A/S

|                  |             |            |          |
|------------------|-------------|------------|----------|
| A                | New drawing | 08-12-2011 | MRH      |
| REV              | DESCRIPTION | DATE       | APPROVED |
| REVISION HISTORY |             |            |          |

# PARTS LIST

| ITEM | QTY | PART NUMBER | DESCRIPTION             |
|------|-----|-------------|-------------------------|
| 1    | 1   | 206460      | Footvalve SPDK/8032     |
| 2    | 1   | 206464      | Spring for foot pedal   |
| 3    | 2   | 215765      | Swivel elbow Ø6mm 1/4"  |
| 4    | 1   | 216537      | Swivel elbow Ø8 1/4"    |
| 5    | 2   | 216797      | Silencer 1/4" T40C-2800 |

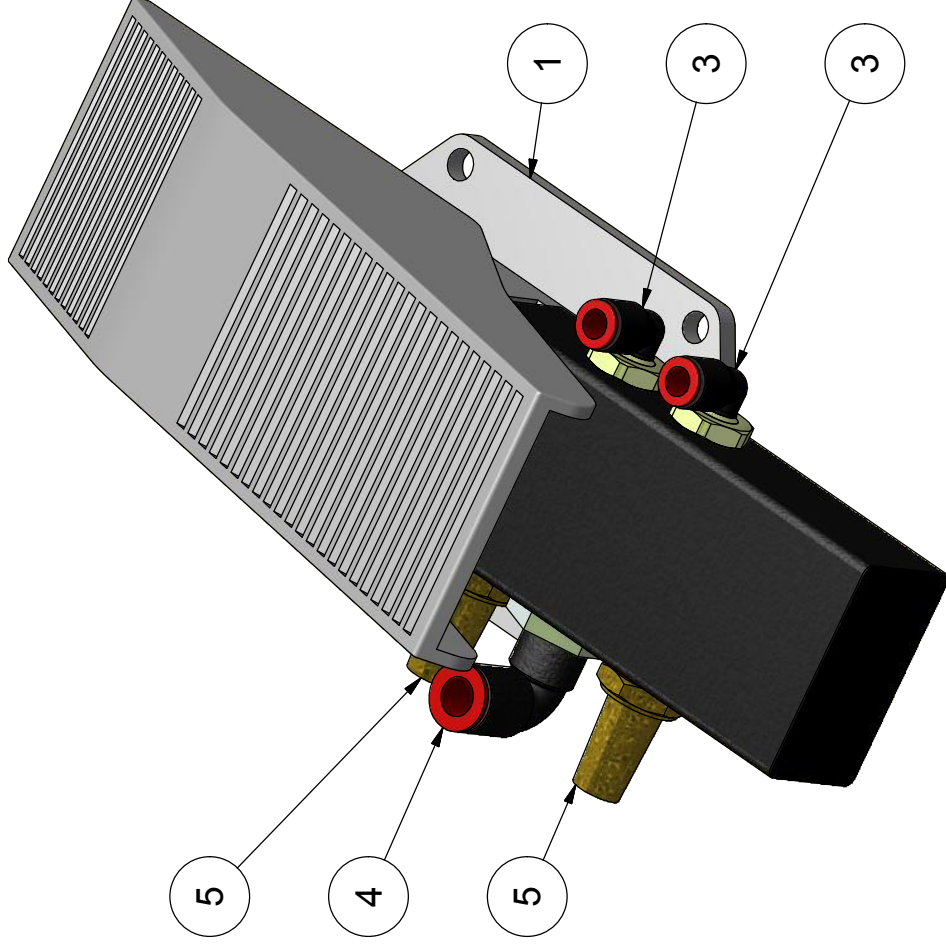

Alle kanter reifes  
Breake all edges



Part No.: 206393

Description:

Fodventil-Højre: 8mm ind-6mm ud

Description:

Scale: 1 : 1,5



Material:

DS/ISO 2768-m

Ikke angivet tolerance iht./ Not specified tolerance according to:

Sheet size: A4

Sheet: 1 / 1

HEDENSTED GRUPPEN A/S  
 This document is strictly confidential and must not be copied or disclosed to any third person.

| REV              | DESCRIPTION | DATE       | APPROVED |
|------------------|-------------|------------|----------|
| A                | New drawing | 08-12-2011 | MRH      |
| REVISION HISTORY |             |            |          |

PARTS LIST

| ITEM | QTY | PART NUMBER | DESCRIPTION                      |
|------|-----|-------------|----------------------------------|
| 1    | 1   | 215074      | Valve-V61B7DDA-XA020             |
| 2    | 2   | 215770      | Swirvel elbow Ø8 1/4"            |
| 3    | 2   | 215925      | Straight connector Ø6mm 1/8"     |
| 4    | 1   | 215934      | Straight connector Ø8x1/4"       |
| 5    | 1   | 216388      | Swirvel T-connector Ø8 1-4       |
| 6    | 1   | 216526      | Straight union ø12x1/4" composi  |
| 7    | 1   | 216527      | Straight union ø12x1/2" composi  |
| 8    | 2   | 216590      | T-piece 1/4                      |
| 9    | 1   | 216683      | Stem reducer Ø8-Ø6               |
| 10   | 1   | 216799      | Silencer 1/2                     |
| 11   | 1   | 217020      | Quick coupling female 1/4" o.    |
| 12   | 1   | 217051      | Quick release coupling male 1/4" |

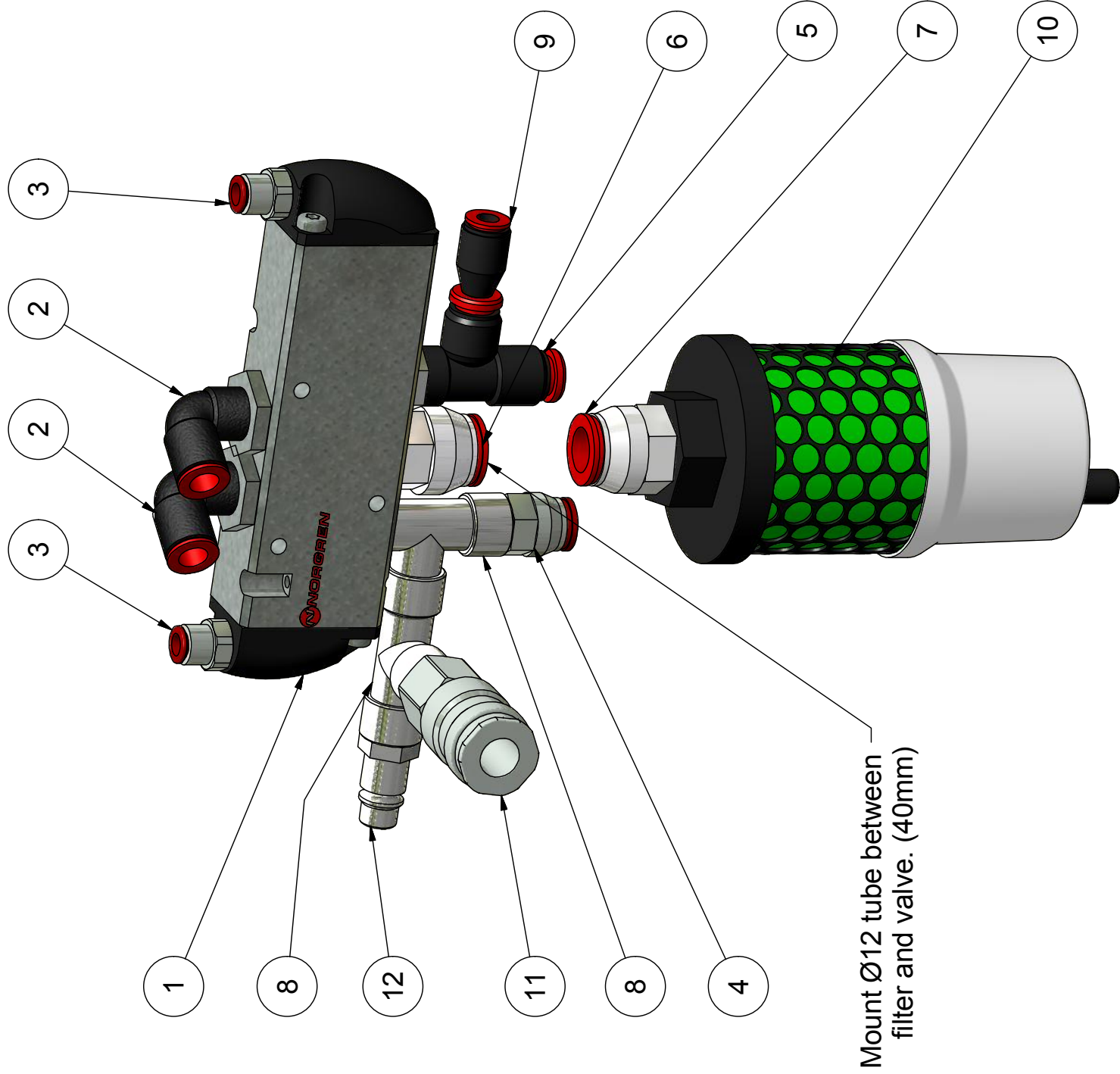

Mount Ø12 tube between filter and valve. (40mm)

Alle kanter reifes  
Breake all edges

|  |  |   |            |               |       |
|--|--|---|------------|---------------|-------|
|  |  | Scale:  | 1 : 1,5    | Sheet size:   | A3    |
|  |  | Ikke angivet tolerance iht/ Not specified tolerance according to: |            | DS/ISO 2768-m |       |
|  |  | Material:   | No         | Sheet:        | 1 / 1 |
|  |  | Part No.:   | 206391     |               |       |
|  |  | Description:  | Main valve |               |       |

| REV | DESCRIPTION    | DATE       | APPROVED |
|-----|----------------|------------|----------|
| A   | New drawing    | 08-12-2011 | MRH      |
| B   | Fittings added | 30-08-2012 | MRH      |
| C   | Coupling added | 10-02-2015 | KL       |
| REV | DESCRIPTION    | DATE       | APPROVED |

REVISION HISTORY



## PARTS LIST

| ITEM | QTY | PART NUMBER | DESCRIPTION                  |
|------|-----|-------------|------------------------------|
| 1    | 1   | 215080      | Valve air activated 5/2      |
| 2    | 2   | 215760      | Swirvel elbow Ø6mm 1/8"      |
| 3    | 1   | 216385      | Tee connector 6-1/8          |
| 4    | 2   | 215925      | Straight connector Ø6mm 1/8" |
| 5    | 2   | 216796      | Silencer 1/8" T40C-1800      |

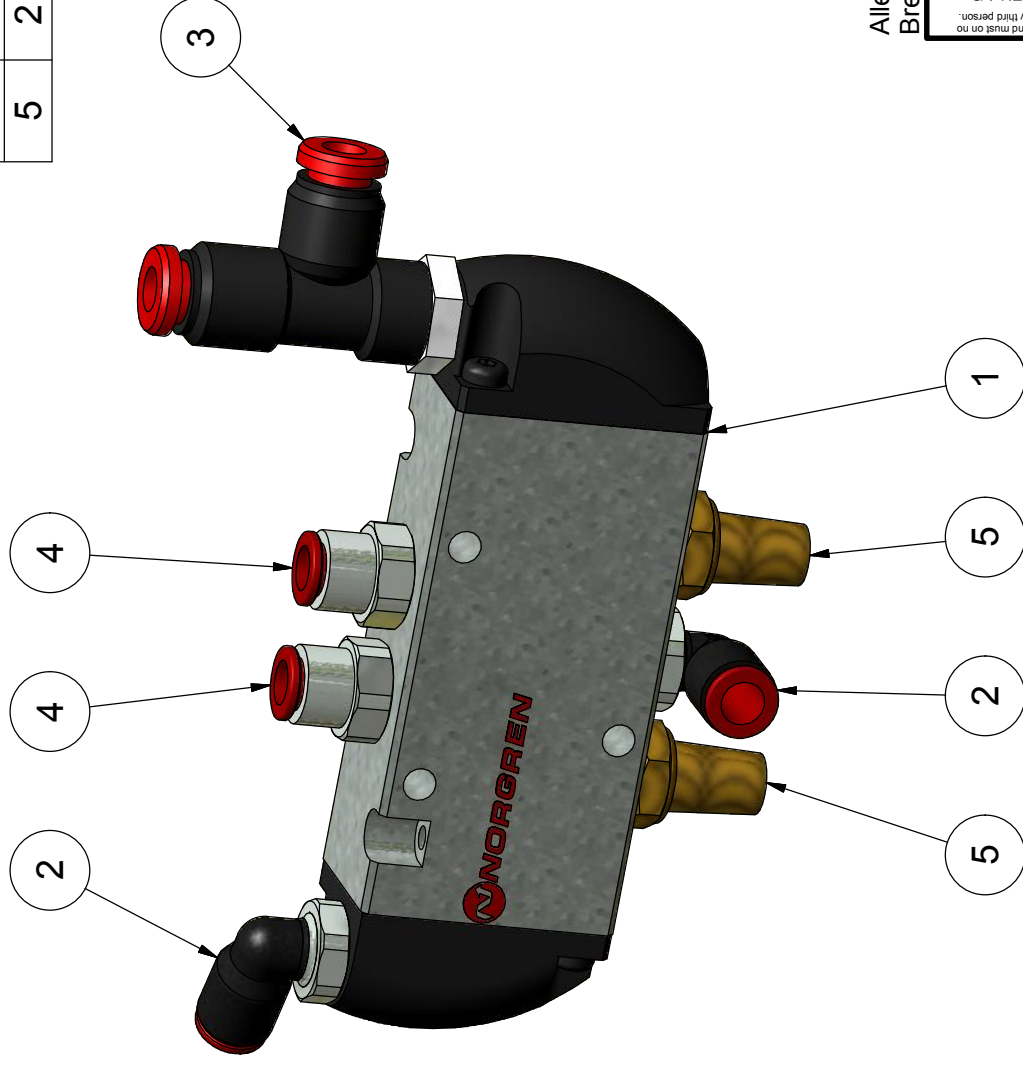

Alle kanter reifes  
Breake all edges



Part No.: 206397

Description: Klampeventil 1

Description:

HEDENSTED GRUPPEN A/S  
 This document is strictly confidential and must not be copied or disclosed to any third person.

Scale: 1 : 1



Material:

Ikke angivet tolerancer iht./ Not specified tolerance according to: DS/ISO 2768-m

Overf. beskaffenhed/Surface properties: No

Sheet size: A4

Sheet: 1 / 1

|                  |                 |            |          |
|------------------|-----------------|------------|----------|
| A                | New drawing     | 08-12-2011 | MRH      |
| B                | Fitting changed | 03-09-2012 | MRH      |
| REV              | DESCRIPTION     | DATE       | APPROVED |
| REVISION HISTORY |                 |            |          |

PARTS LIST

| ITEM | QTY | PART NUMBER | DESCRIPTION                  |
|------|-----|-------------|------------------------------|
| 1    | 1   | 215082      | G1/8 valve 3/2 NC            |
| 2    | 2   | 215765      | Swirvel elbow Ø6mm 1/4"      |
| 3    | 1   | 216385      | Tee connector 6-1/8          |
| 4    | 2   | 216520      | Straight connector Ø6mm 1/8" |

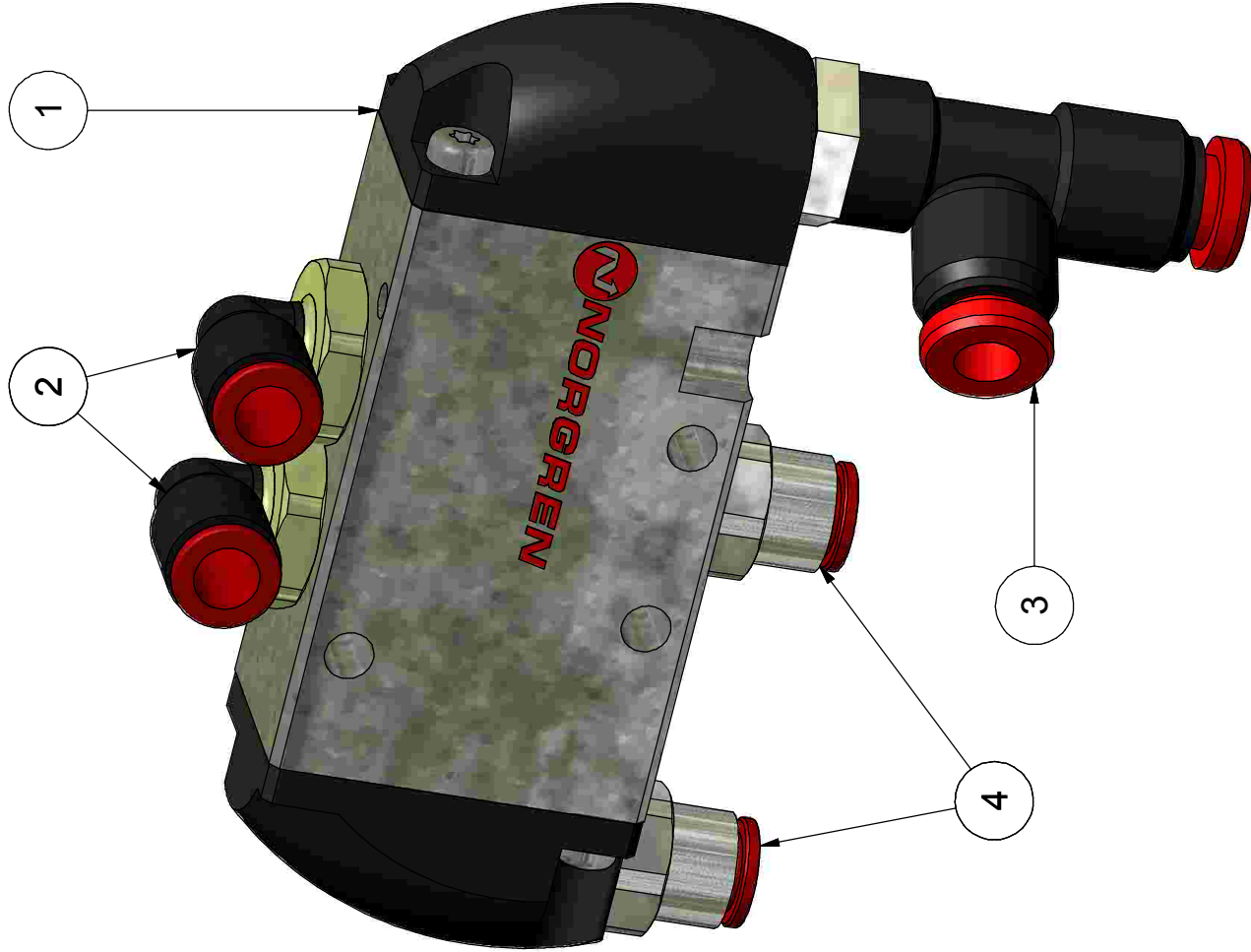

|                  |             |            |          |
|------------------|-------------|------------|----------|
| A                | New drawing | 08-12-2011 | MRH      |
| REV              | DESCRIPTION | DATE       | APPROVED |
| REVISION HISTORY |             |            |          |

Alle kanter reifes  
Breake all edges



This document is strictly confidential and must on no account be copied or disclosed to any third person.  
HEDENSTED GRUPPEN A/S

Scale:  
1,5 : 1



Ikke angivet tolerancer iht./Not specified tolerance according to:

DS/ISO 2768-m

Sheet size:

A4

Overt. beskaffenhed/Surface properties:

No

Sheet:

1 / 1

Material:

Part No.: 206389

Description:

Klampeventil 2

Description:

PARTS LIST

| ITEM QTY | PART NUMBER | DESCRIPTION                |
|----------|-------------|----------------------------|
| 1 8      | 10206016    | Bolt. unbraco cyl 6x16 FZB |
| 2 2      | 11408025    | Hexagon bolt M8x25 FZB     |
| 3 2      | 17908000    | Self-locking nut M8 FZB    |
| 4 1      | 205270      | Leg clamp assembly 1       |
| 5 1      | 205275      | Leg clamp assembly 2       |
| 6 1      | 210303      | Cylinder RA/192040/M/40    |
| 7 1      | 210428      | Lock nut MP150190_M12x1,25 |
| 8 1      | 214115      | F-Joint QM-8025-25         |
| 9 1      | 214160      | L-Joint QA-8040-24         |
| 10 2     | 215760      | Swirvel elbow Ø6mm 1/8"    |

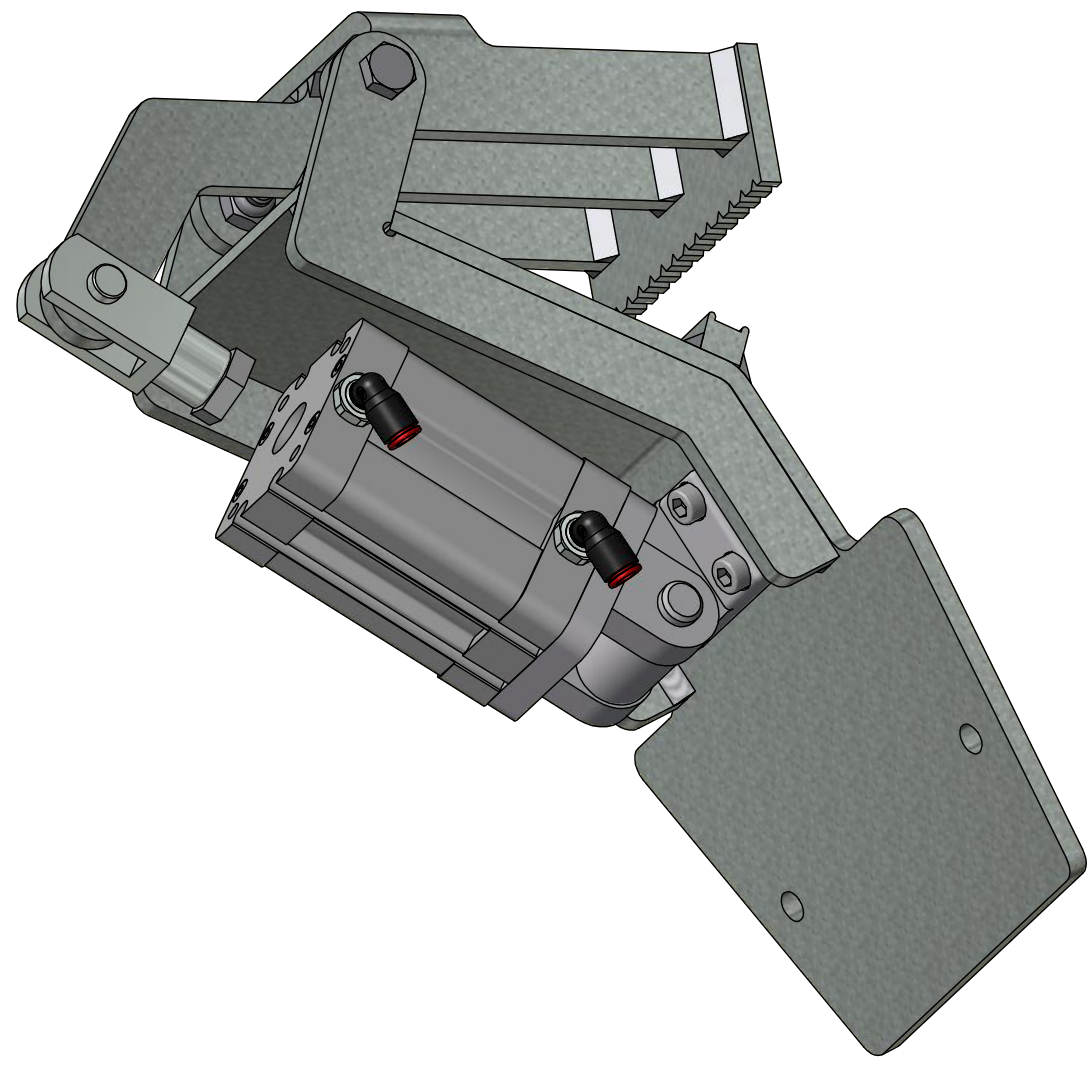
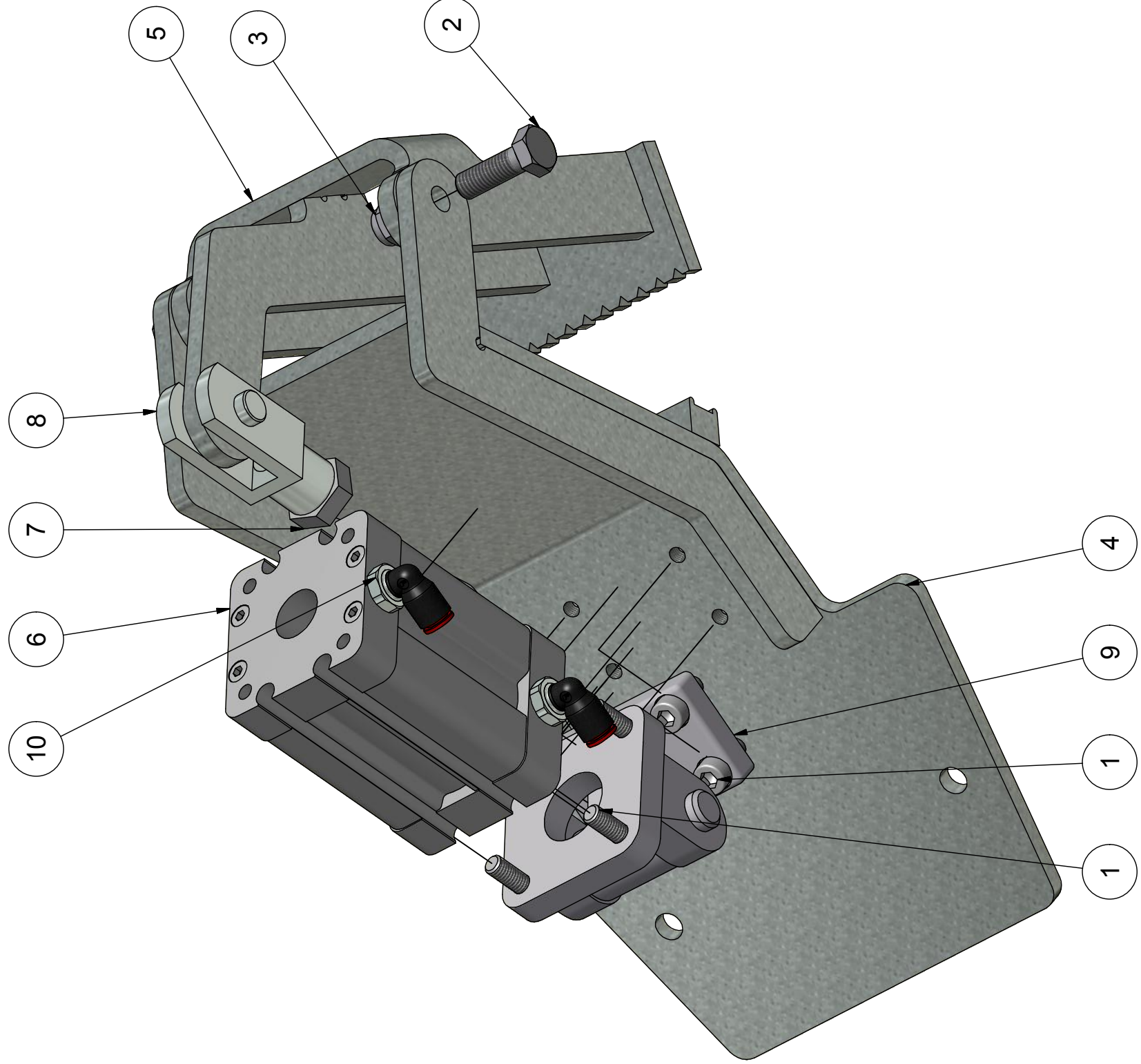

Alle kanter reifes  
Breake all edges

**HEDENSTED GRUPPEN A/S**  
 HEDENSTED GRUPPEN A/S  
 Heddensted Gruppen  
 116

Scale: 1:2  
 Ikke angivet tolerance iht/ Not specified tolerance according to: DS/ISO 2768-m  
 Overfl. beskaffenhed/Surface properties: No

Material: 205278  
 Part No.: 205278  
 Description: Leg clamp assembly

Sheet size: A3  
 Sheet: 1/2

This document is strictly confidential and must not be copied or disclosed to any third person.

|                  |             |            |          |
|------------------|-------------|------------|----------|
| A                | Made        | 20-06-2013 | MRH      |
| REV              | DESCRIPTION | DATE       | APPROVED |
| REVISION HISTORY |             |            |          |



PARTS LIST

| ITEM | QTY    | PART NUMBER | DESCRIPTION                 |
|------|--------|-------------|-----------------------------|
| 1    | 2      | 10204050    | Bolt unbraco cyl 4x50 FZB   |
| 2    | 2      | 11408030    | Hexagon bolt M8x30 FZB      |
| 3    | 1      | 205200      | Body remover - Arm assembly |
| 4    | 1      | 205248      | Valve for body mover        |
| 5    | 1      | 215850      | T-stykke Udv. Ø6 x 6mm      |
| 6    | 2      | 215865      | Swivel Tee Ø6 female 1-8 2  |
| 7    | 2      | 215985      | Banjo flow control Ø4 1/8"  |
| 8    | 2,80 m | 216104      | Air hose Ø4mm pur red       |
| 9    | 5,20 m | 216106      | Air hose Ø4mm pur blue      |
| 10   | 0,10 m | 216116      | Air hose Ø6mm pur red       |

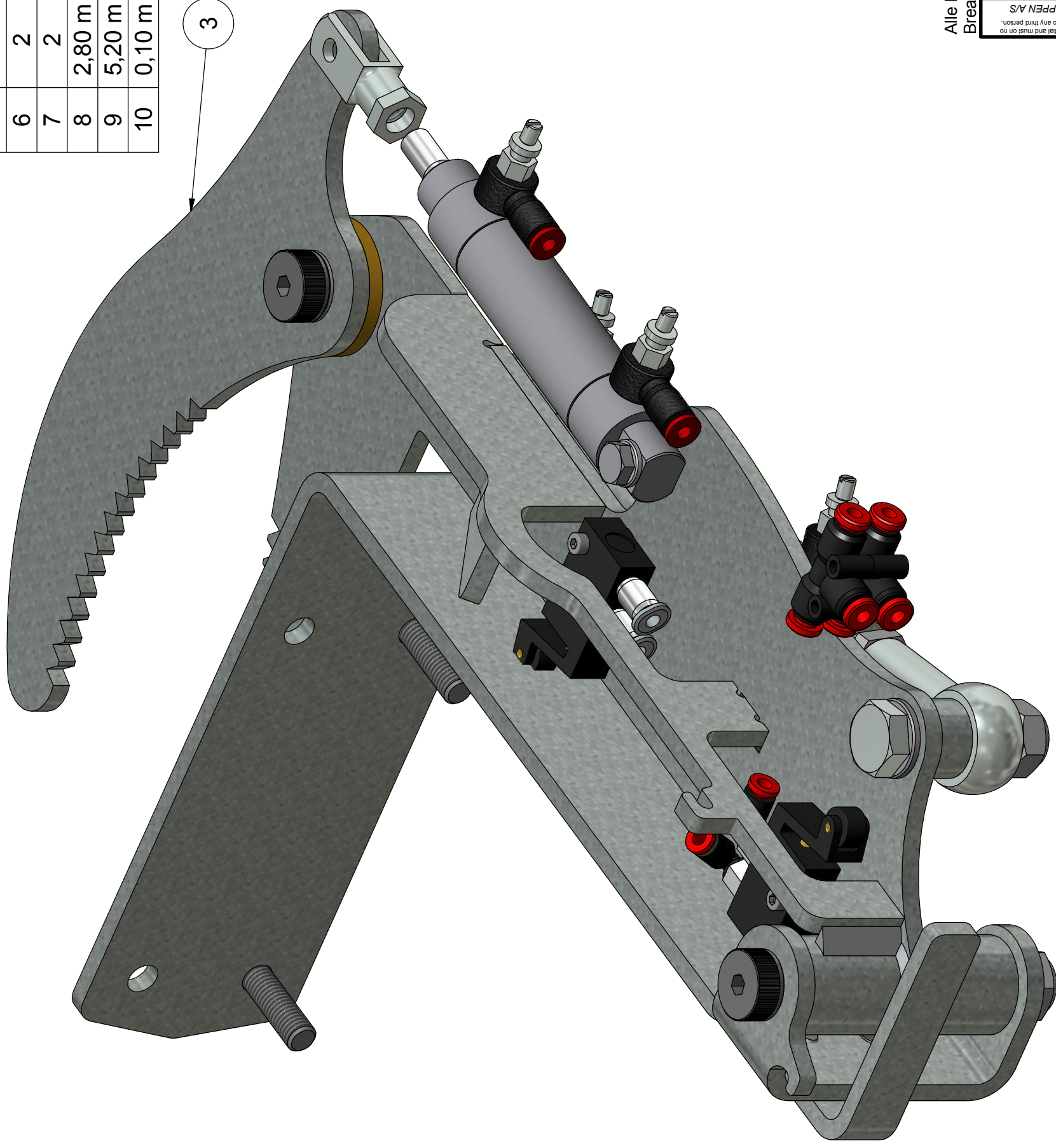

Alle kanter reifes  
Breake all edges



Part No.: 205252

Description: Body remover

Description:

Scale: 1 : 1,2

Ikke angivet tolerancer iht/ Not specified tolerance according to: DS/ISO 2768-m

Sheet size: A3

Overfl. beskaffenhed/Surface properties: No

Sheet: 1 / 2

This document is strictly confidential and must not be copied or disclosed to any third person.  
HEDENSTED GRUPPEN A/S

| REV | DESCRIPTION | DATE       | MRH      |
|-----|-------------|------------|----------|
| A   | Made        | 29-10-2012 | MRH      |
|     |             |            | APPROVED |

REVISION HISTORY



E (1:5)

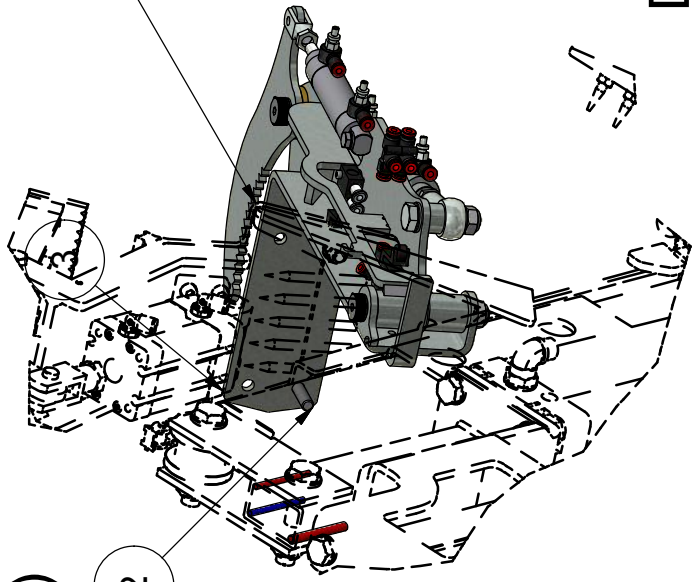

Use det bolts from the clamp  
to mount the Body remover.  
Mount in the bottom holes af bracket.

2

D (1:2)

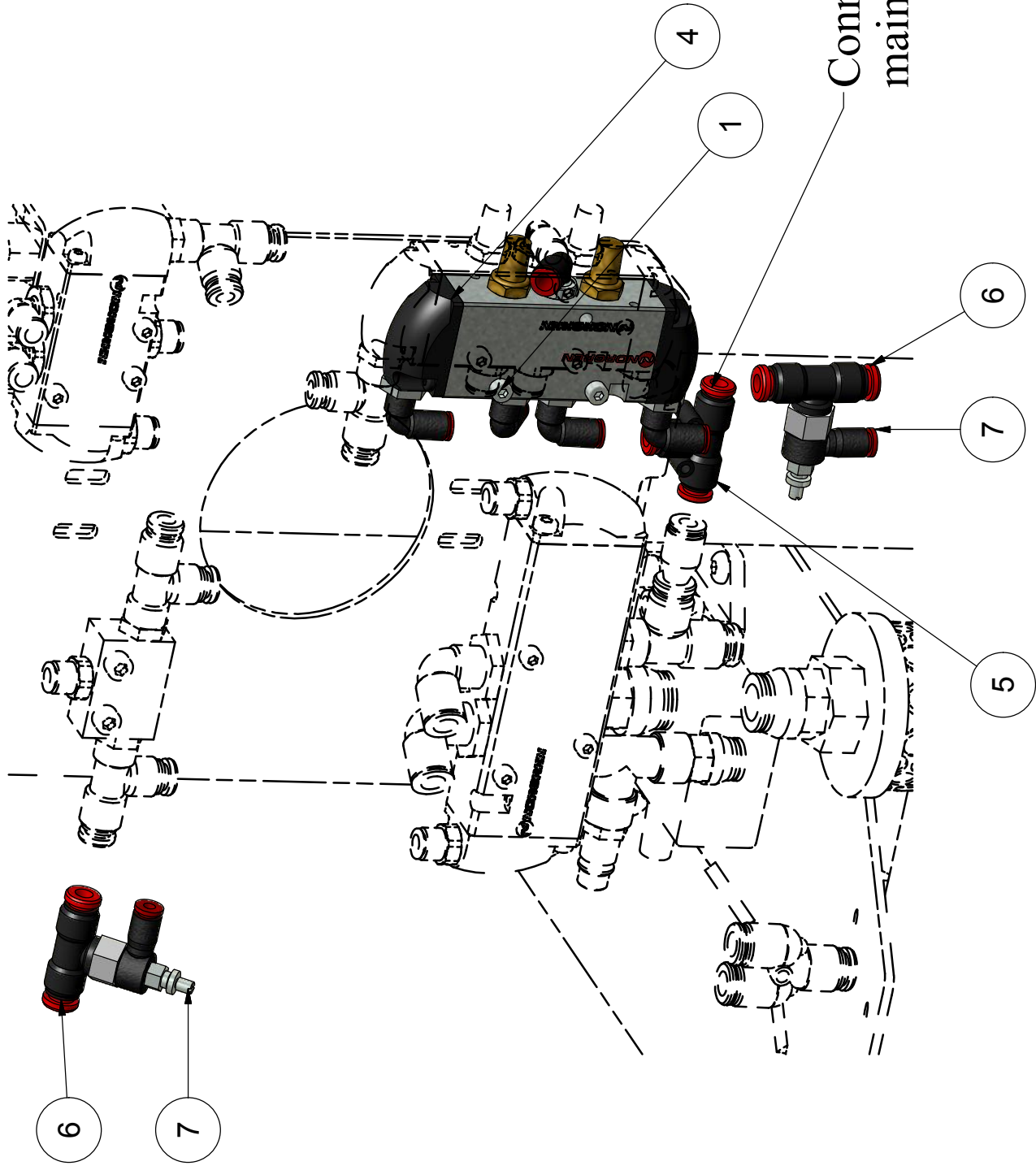

Connect with the  
main air supply

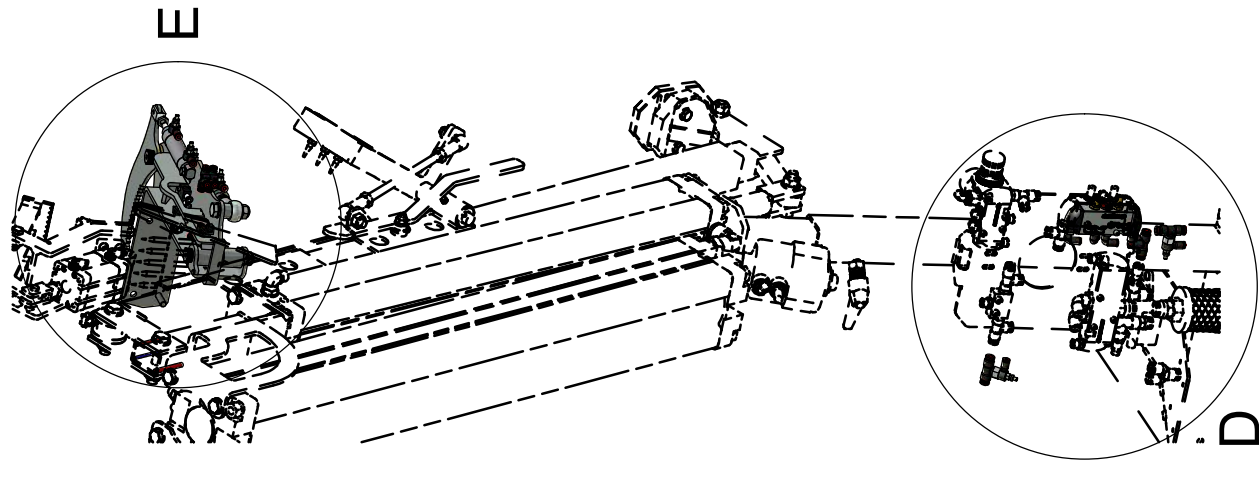

E

D

Alle kanter reifes  
Breake all edges



HEDENSTED GRUPPEN A/S  
This document is strictly confidential and must not be  
account be copied or disclosed to any third person.

|              |              |  |               |             |     |
|--------------|--------------|--|---------------|-------------|-----|
| Scale:       | 1:1,2        | Ikke angivet tolerancer iht/ Not specified tolerance according to: | DS/ISO 2768-m | Sheet size: | A3  |
|              |              | Overfil, beskaffenhed/Surface properties:                          | No            | Sheet:      | 2/2 |
| Part No.:    | 205252       | Material:  |               |             |     |
| Description: | Body remover |  |               |             |     |

PARTS LIST

| ITEM | QTY    | PART NUMBER | DESCRIPTION                 |
|------|--------|-------------|-----------------------------|
| 1    | 4      | 10203020    | Bolt unbraco cyl 3x20 FZB   |
| 2    | 2      | 11406012    | Hexagon bolt M6x12 FZB      |
| 3    | 1      | 11406025    | Hexagon bolt M6x25 FZB      |
| 4    | 1      | 11408030    | Hexagon bolt M8x30 FZB      |
| 5    | 1      | 11410045    | Hexagon bolt M10x45 FZB     |
| 6    | 4      | 1504000     | Nut M4 FZB                  |
| 7    | 1      | 17906000    | Self-locking nut M6 FZB     |
| 8    | 1      | 17908000    | Self-locking nut M8 FZB     |
| 9    | 3      | 17910000    | Self-locking nut M10 FZB    |
| 10   | 1      | 20210016    | Fitting bolt M10-12x16mm    |
| 11   | 1      | 20210070    | Fitting bolt M10-12x70mm    |
| 12   | 1      | 205212      | Front clamp                 |
| 13   | 1      | 205215      | Base plate                  |
| 14   | 1      | 205220      | Back clamp                  |
| 15   | 1      | 205230      | Aktivator plate             |
| 16   | 1      | 205235      | Brass ring                  |
| 17   | 1      | 205245      | Brush for cylinder          |
| 18   | 2      | 208040      | Mini airvalve M/1553/8      |
| 19   | 1      | 210421      | Lock nut M/P1501/60         |
| 20   | 1      | 210427      | Lock nut MP150189_M10x1,25  |
| 21   | 1      | 211018      | Cylinder RT-57225-M-80      |
| 22   | 1      | 211622      | Cylinder RT/57220/M/40      |
| 23   | 1      | 214105      | F-Joint QM-57020-25         |
| 24   | 1      | 214116      | UF-Joint QM-8025-32         |
| 25   | 2      | 215752      | Swivel elbow Mini - Ø4-M5   |
| 26   | 2      | 215848      | T-stykke Udv. Ø4            |
| 27   | 4      | 215987      | Banjo flow control Ø4 1/8"  |
| 28   | 0,91 m | 216106      | Air hose Ø4mm pur blue      |
| 29   | 2      | 216522      | Stright union Mini - Ø4-M5  |
| 30   | 4      | 423423      | Slide Bearing PAF 12070 P10 |
| 31   | 3      | 82106000    | Washer M6 FZB               |
| 32   | 1      | 82108000    | Washer M8 FZB               |
| 33   | 2      | 82110000    | Washer M10 FZB              |

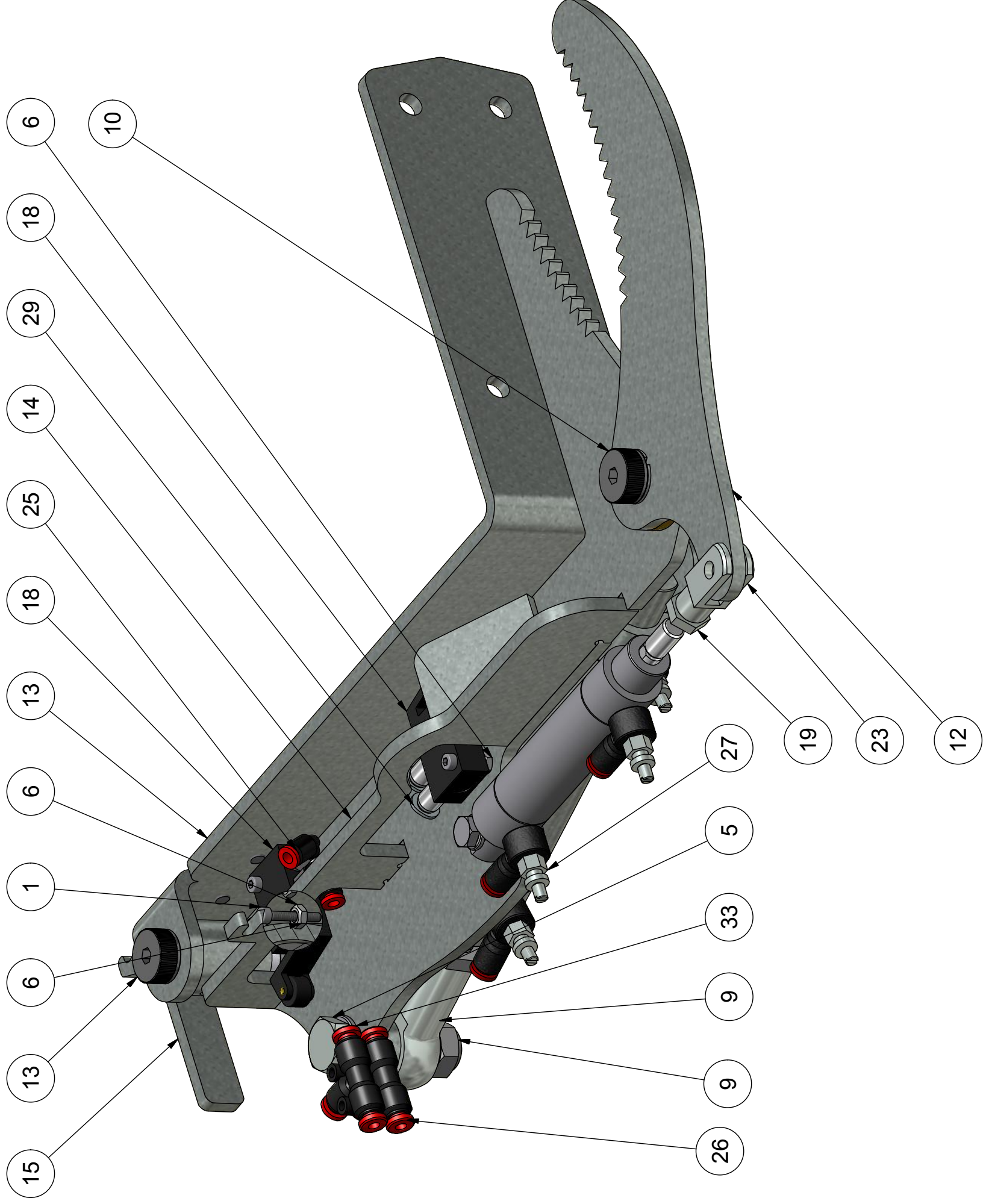

Alle kanter reifes  
Breake all edges

|  |                             |   |                |
|--|-----------------------------|---|----------------|
|  |                             | Scale: 1:1,5<br>Ikke angivet tolerance iht/ Not specified tolerance according to: DS/ISO 2768-m | Sheet size: A3 |
| HEDENSTED GRUPPEN A/S<br>account be copied or disclosed to any third person. |                             | Overfl. beskaffenhed/Surface properties: No   | Sheet: 1/3     |
| Part No.:  | 205200                      | Material:   |                |
| Description:   | Body remover - Arm assembly |   |                |

| REV | DESCRIPTION  | DATE       | APPROVED |
|-----|--------------|------------|----------|
| A   | New drawing  | 12-02-2012 | MRH      |
| B   | Bolt changed | 25-08-2014 | MRH      |
|     |              |            |          |

REVISION HISTORY

PARTS LIST

| ITEM | QTY | PART NUMBER | DESCRIPTION             |
|------|-----|-------------|-------------------------|
| 1    | 1   | 215080      | Valve air activated 5/2 |
| 2    | 4   | 215755      | Swirvel elbow Ø4 1/8"   |
| 3    | 1   | 215760      | Swirvel elbow Ø6mm 1/8" |
| 4    | 2   | 216796      | Silencer 1/8" T40C-1800 |

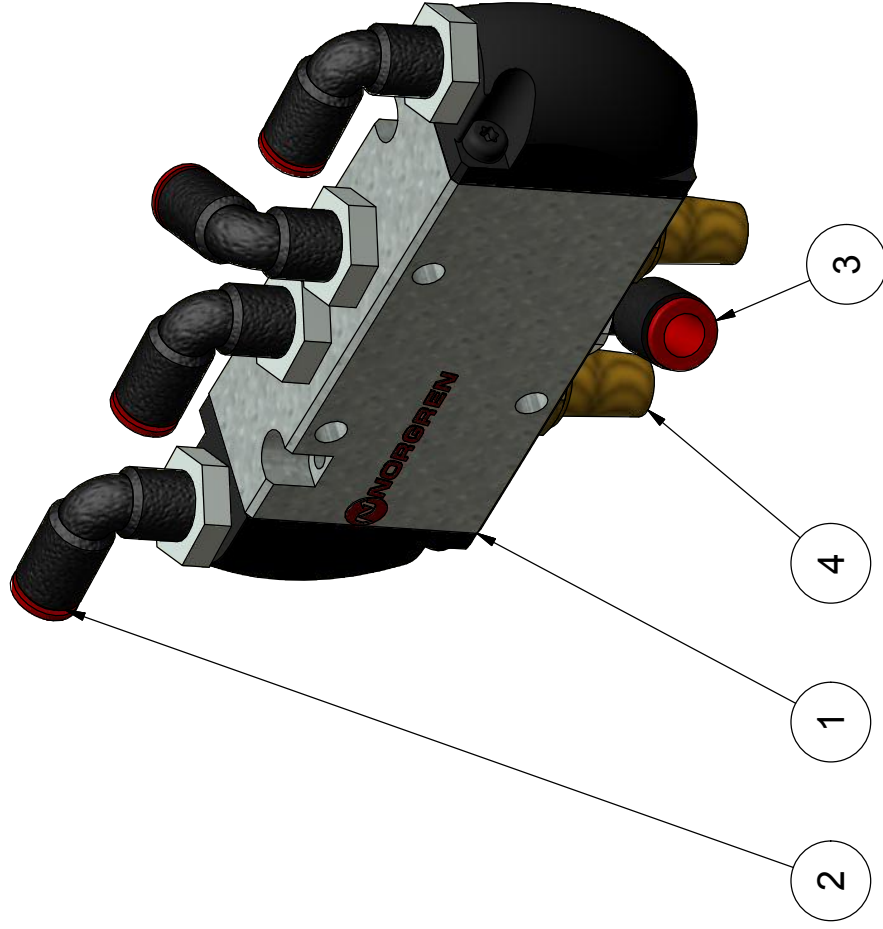

Alle kanter reifes  
Breake all edges



Part No.: 205248

Description:

Valve for body mover

Description:

Scale: 1:1



Material:

DS/ISO 2768-m

Ikke angivet tolerance iht./ Not specified tolerance according to:

Sheet size: A4

Overfitt. beskaffenhed/Surface properties: No

Sheet: 1/1

This document is strictly confidential and must not be copied, reproduced or disclosed to any third person.  
HEDENSTED GRUPPEN A/S

|                  |             |            |          |
|------------------|-------------|------------|----------|
| A                | Made        | 30-10-2012 | MRH      |
| REV              | DESCRIPTION | DATE       | APPROVED |
| REVISION HISTORY |             |            |          |

## 10 Tekniske data

|                     |   |                   |
|---------------------|---|-------------------|
| Trykluft            | : | 7 bar             |
| Luftforbrug pr. min | : | 37 l              |
| Hydraulikolie       | : | Statoil Hayden 10 |
|                     |   | Mængde : 5 liter  |

### Olie

|         |            |
|---------|------------|
| Længde: | 89 cm      |
| Bredde: | 64 cm      |
| Højde : | 202-235 cm |
| Vægt:   | 70 kg.     |

# 11 Luftdiagrammer

## 11.1 Luftdiagram på Flåmaskine Light Olive.

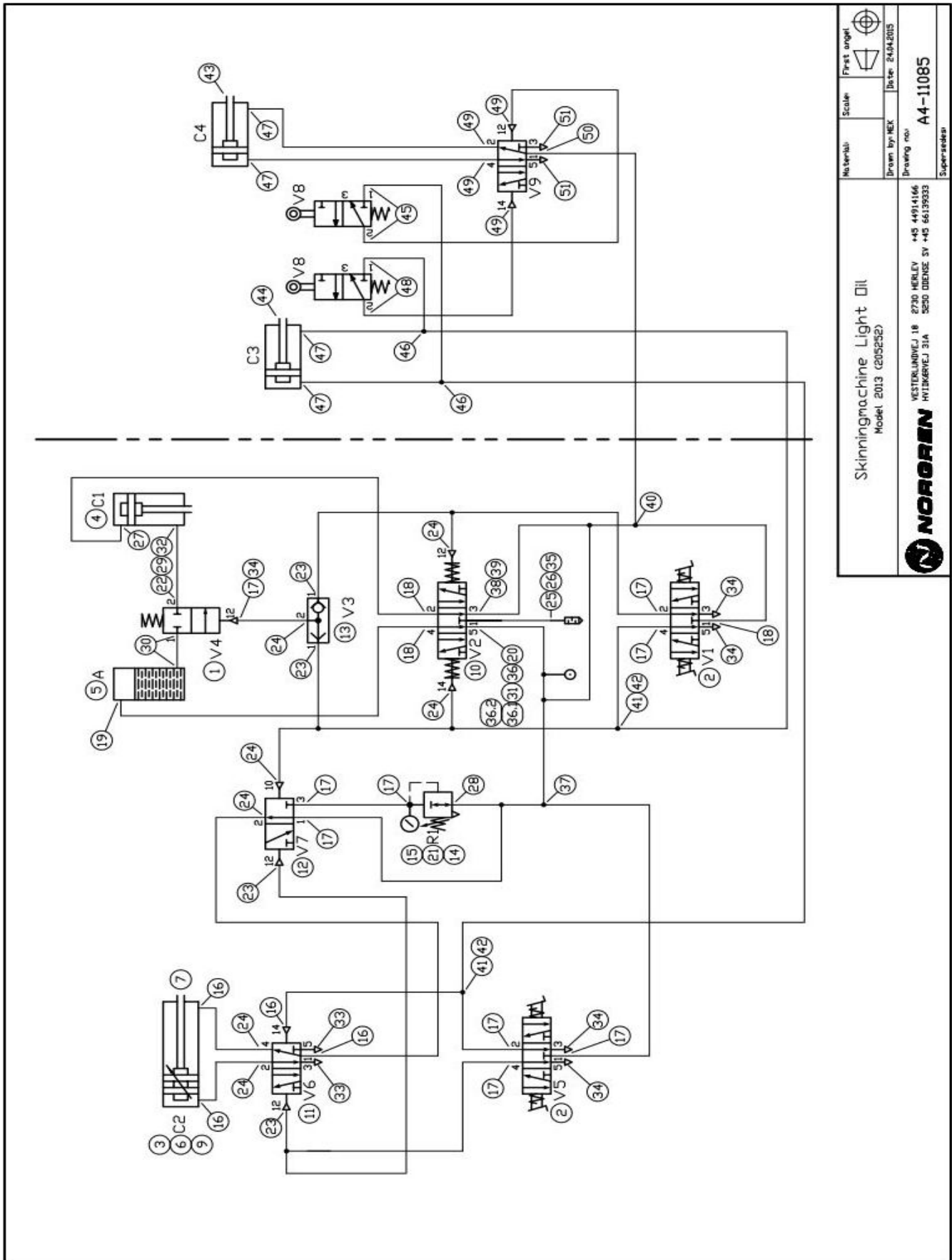

|  |  |               |          |              |
|--|--|---------------|----------|--------------|
| Skinningmachine Light Oil  |  | Material:     | Scale:   | First angle: |
| Model 2013 (20S2S2)  |  | Drawn by: MEK | Sheet:   | 24/24/2015   |
|  VESTERLUNDVEJ 18 2720 HØRLEV +45 44914166<br>HYTTEVEJ 31A 5250 DIBENSØ SV +45 66193533 |  | Drawing no:   | A4-11085 |              |
|  |  | Supervised:   |          |              |

-K- vedhæft 1 til pag 11085

## 12 EU-overensstemmelseserklæring

Hedensted Gruppen A/S  
Vejlevej 15  
Dk-8722 Hedensted  
Tlf. 7589 1244  
Fax 7589 1180

- erklærer hermed at :

Flåmaskine Flå Light Olie 2012  
Typenummer 206400

- er i overensstemmelse med:

Maskindirektivet 2006/42/EF

- under anvendelse af harmoniserede standarder.

DS/EN ISO 12100-1 :2005  
DS/EN 60439-3  
DS/EN ISO 13857 :2008

Hedensted, den, 21/9-2012

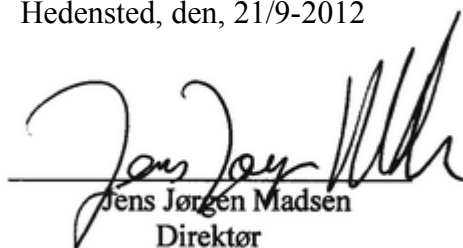

Jens Jørgen Madsen  
Direktør