

PRODUKT DATABLAD

FL2 OG FL3

FITTINGS
SPECIALISTEN

FLOWREGULATOR

til væske (FL2) og luft (FL3) m/panelmontering

	FL2	FL3																		
Str.	ml/min	L/min	BSPT	±	A	B	C	D	E	F										
-1	16-160	1-5	1/4"	±4%	102	30	25	20	M18x1.5	77										
-2	80-400	2-10																		
-3	100-500	3-15																		
-4	100-600	4-20																		
-5	200-800	5-25																		
-6	100-1000	6-30																		
-7	2,5-25 LPH		1/2"	±4%	110	25	25	20	M18x1.5	80										
-8	5-45 LPH																			
-9	6-60 LPH																			
Str.	LPM	Nm ³ /h									BSPT		A	B	C	D	E	F	G	H
-10		0,1-1									1"	±4%	175	32	168	35	25	76	25	127
-11		0,6-6																		
-12	10-100 LPH																			
-13	16-160 LPH																			
-14	25-250 LPH																			
-15	0,5-4 LPM	1-10																		
-16	1-7 LPM	1,6-16																		
-17	1-11 LPM	2,5-25																		
-18	2-18 LPM	4-40																		
-19	5-35 LMP	10-100	1"	±4%	234	45	226	46	33	100	37	160								
-20	10-50 LMP	20-100																		
-21	10-70 LMP	16-160																		
-22	10-130 LMP	25-250																		
-23	10-150 LMP	30-300																		
-24	10-170 LMP																			



FL2 til væske

FL3 til luft

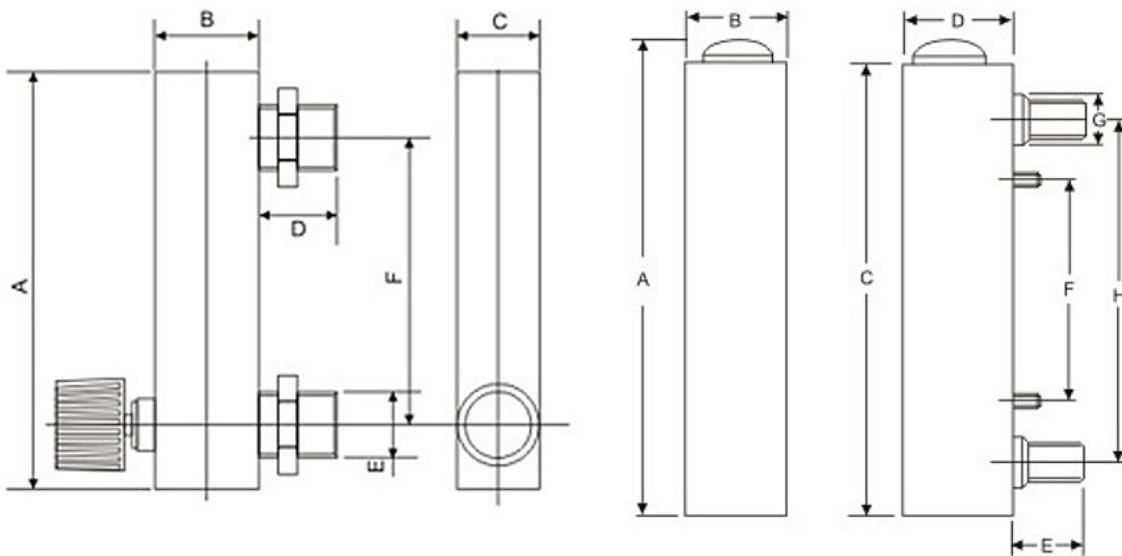

FITTINGS SPECIALISTEN A/S
Navervej 8 · DK-7000 Fredericia
Tel. (+45) 75 945 955

WWW.FITTINGS.DK