

- Lagerstandard / *in stock*
- ▶ innerhalb weniger Tage / *within a few days*
- auf Anfrage / *on request*
- ✘ auslaufende Größe / *as stock lasts*

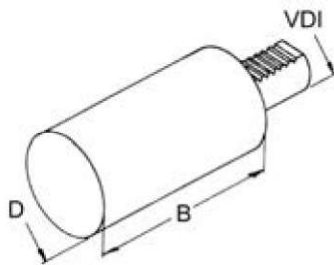

Typ A2, Werkzeughalter-Rohling, rund*

Type A2, round soft blank*



VDI	D mm	B mm	●
16	40	60	●
20	50	70	●
25	58	80	●
25	58	200	●
30	68	100	●
30	68	240	●
40	83	120	●
40	83	320	●
50	98	135	●
50	98	400	●
60	123	150	●
60	123	480	●

* Material: 42 CrMo 4