

Präzisions-Schneideisen
 DIN EN 22568
 Metrisches ISO-Gewinde DIN 13

Precision thread cutting dies
 DIN EN 22568
 ISO metric thread DIN 13

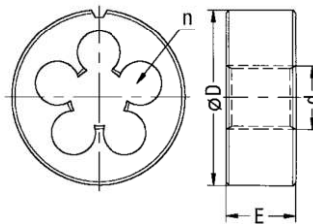

ORDER-CODE → RU →		Schäl		Autom		70°		6e		LH	
d ↓	P mm	Ø D x E mm	n	HSS 6g Schäl. spiral entry ≤ M 1,4 Tol. 6h x = 1.75 · P	HSS 6g Schäl. spiral entry x = 1.75 · P	HSS 6g Schäl. ab M 3 spiral entry M 3 and above x = 1.75 · P	HSS 6g Anschn. kurz Schäl. ab M 3 short chamfer spiral entry M 3 and above x = 1.25 · P	HSS 6e Schäl. ab M 3 spiral entry M 3 and above x = 1.75 · P	HSS 6g links Schäl. ab M 3 left hand spiral entry M 3 and above x = 1.75 · P	Art.-Nr.	Art.-Nr.
M 1	0,25	16 x 5	3	101212		siehe S./see					
M 1,1	0,25	16 x 5	3	101222							
M 1,2	0,25	16 x 5	3	101224							
M 1,4	0,3	16 x 5	3	101238							
M 1,6	0,35	16 x 5	3	101261		siehe Seite see page					
M 1,7	0,35	16 x 5	3	101276							
M 1,8	0,35	16 x 5	3	101291							
M 2	0,4	16 x 5	3	101816							
M 2	0,4	16 x 5	4			101821	141023	101828	101835		
M 2,2	0,45	16 x 5	3	101852							
M 2,2	0,45	16 x 5	4			s. VA S./see \					
M 2,3	0,4	16 x 5	3	101865							
M 2,3	0,4	16 x 5	4			101868					
M 2,5	0,45	16 x 5	3	101879							
M 2,5	0,45	16 x 5	4			101881	101895	101888	101893		
M 2,6	0,45	16 x 5	3	101911							
M 2,6	0,45	16 x 5	4			101914			101921		
M 3	0,5	20 x 5	3	102207	105131						
M 3	0,5	20 x 5	4			102210	102244	102225	105132		
M 3	0,5	20 x 5	5								
M 3,5	0,6	20 x 5	3	102272	105143						
M 3,5	0,6	20 x 5	4			102275		102284	105144		
M 4	0,7	20 x 5	3	102470	105234						
M 4	0,7	20 x 5	4			102473	102501	102484	105235		
M 4-5	0,7	20 x 5	5			s. LLS./see					
M 4,5	0,75	20 x 7	4	102552	105243						
M 5	0,8	20 x 7	4	102642	105289			102676	102659	105290	
M 5-5	0,8	20 x 7	5			s. LLS./see					

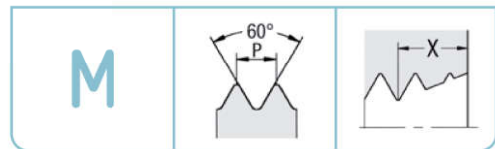
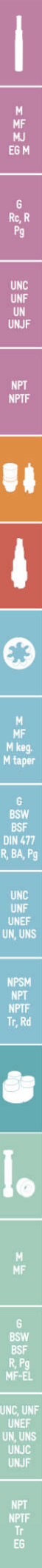

Präzisions-Schneideisen
 DIN EN 22568
 Metrisches ISO-Gewinde DIN 13

Precision thread cutting dies
 DIN EN 22568
 ISO metric thread DIN 13

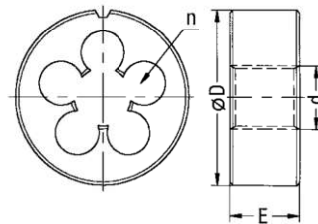
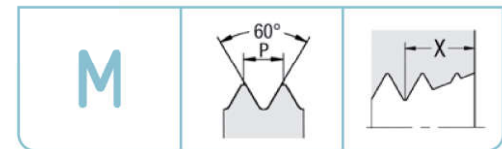

ORDER-CODE → RU →		Schäl		Autom		70°		6e		LH	
d ↓	P mm	Ø D x E mm	n	HSS 6g Schäl. spiral entry x = 1.75 · P	HSS 6g Schäl. spiral entry x = 1.75 · P	HSS 6g Schäl. spiral entry x = 1.75 · P	HSS 6g Anschn. kurz Schäl. short chamfer spiral entry x = 1.25 · P	HSS 6e Schäl. spiral entry x = 1.75 · P	HSS 6g links Schäl. left hand spiral entry x = 1.75 · P	Art.-Nr.	Art.-Nr.
M 6	1	20 x 7	4	102771	105347		102797	102785	105348		
M 6-5	1	20 x 7	5			102773					
M 7	1	25 x 9	4	102888	105391			102895	105392		
M 8	1,25	25 x 9	4	102959	105419			102975	105420		
M 8	1,25	25 x 9	5			102961	102990	102978			
M 9	1,25	25 x 9	4	103098	105450				105451		
M 9	1,25	25 x 9	5								
M 10	1,5	30 x 11	4	101297	104875			101314	104876		
M 10	1,5	30 x 11	5			101300	101326				
M 11	1,5	30 x 11	4	101411	104897				104898		
M 11	1,5	30 x 11	5								
M 12	1,75	38 x 14	4	101439	104908			101447	104909		
M 12	1,75	38 x 14	5			101442	101458				
M 14	2	38 x 14	4	101558	104936			101566	104937		
M 14	2	38 x 14	5			s. VA S/see\					
M 16	2	45 x 18	4	101657	104965			101665	104966		
M 16	2	45 x 18	5			s. VA S/see\					
M 18	2,5	45 x 18	5	101746	104987				104988		
M 20	2,5	45 x 18	5	101934	105025			101938	105026		
M 22	2,5	55 x 22	5	102002	105051				105052		
M 22	2,5	55 x 22	6								
M 24	3	55 x 22	5	102060	105072				105073		
M 24	3	55 x 22	6								
M 27	3	65 x 25	5	102150	105107				105108		
M 27	3	65 x 25	6								
M 30	3,5	65 x 25	6	102316	105152				105153		
M 33	3,5	65 x 25	6	102372	105179				105180		
M 36	4	65 x 25	7	102415	105205				105206		
M 39	4	75 x 30	6	102455	105227						

Präzisions-Schneideisen
 DIN EN 22568
 Metrisches ISO-Gewinde DIN 13

Precision thread cutting dies
 DIN EN 22568
 ISO metric thread DIN 13

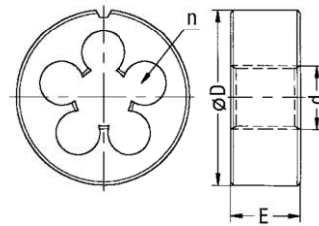
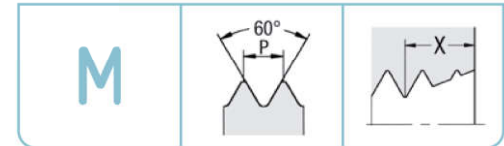

ORDER-CODE → RU →				Schäl	Autom	70°	6e	LH
d ↓	P mm	Ø D x E mm	n	HSS 6g Schäl. spiral entry x = 1.75 · P	HSS 6g Schäl. spiral entry x = 1.75 · P	HSS 6g Anschn. kurz Schäl. short chamfer spiral entry x = 1.25 · P	HSS 6e Schäl. spiral entry x = 1.75 · P	HSS 6g links Schäl. left hand spiral entry x = 1.75 · P
				Art.-Nr.	Art.-Nr.	Art.-Nr.	Art.-Nr.	Art.-Nr.
M 42	4,5	75 x 30	7	102587	105255			105256
M 45	4,5	90 x 36	7	108325	105270			
M 48	5	90 x 36	7	102630	105281			
M 52	5	90 x 36	7	102740	105321			
M 56	5,5	105 x 36	7	102757	105334			
M 60	5,5	105 x 36	8	102863	105368			
M 64	6	105 x 36	8	102872	105378			

M
MF
MJ
EG M

G
Rc, R
Pg

UNC
UNF
UN
UNJF

NPT
NPTF

M
MF
M keg.
M taper

G
BSW
BSF
DIN 477
R, BA, Pg

UNC
UNF
UNEF
UN, UNS

NPSM
NPT
NPTF
Tr, Rd

M
MF

G
BSW
BSF
R, Pg
MF-EL

UNC, UNF
UNEF
UN, UNS
UNJC
UNJF

NPT
NPTF
Tr
EG