

Miter Rule 3D 45°

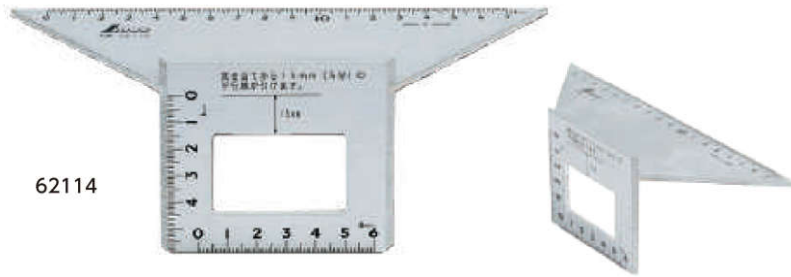

62114

Features

- Mark precise 45° angles both left and right just by sliding the Miter Rule. No need to reverse the gauge itself.
- Excellent stability
- Convenient to work on baseboard corners

Use

- For testing precise 45° and 90° angles
- For marking the base layout of a 45° angle

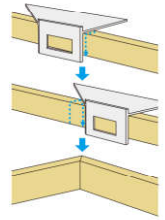

Specifications

Angle Tolerance	Less than 0.2 mm per 100 mm
Length Tolerance	±0.2 mm
Material	Aluminum

Item Code	Description	Overall Length×Height×Thickness (mm)	Weight (g)	JAN Code	Packing Unit	Packaging
62114	Aluminum	200×63×73	100	4 960910 621145	6	C

Sliding Bevel



33919

33921

Features

- Can be adjusted to any angle
- Lightweight and solid aluminum handle
- Fixing screw on the tail doesn't get in the way

Use

- Scribing and drawing of any angle
- For scribing dovetail or ink scribing

Specifications

Material	Blade: Stainless steel	Handle: Aluminum
----------	------------------------	------------------

Item Code	Description	Length×Width×Thickness (mm)	Weight (g)	JAN Code	Packing Unit	Packaging
33919	SB-8 8"	235×22×17	120	4 960910 339194	6	SP
33921	SB-10 10"	285×25×17	160	4 960910 339217	6 (60)	SP

Japanese Bevel

62502



Features

- Can be adjusted to any angle

Use

- Scribing and drawing of any angle



Specifications

Material	Stainless steel
----------	-----------------

Item Code	Description	Length×Width×Thickness (mm)	Weight (g)	JAN Code	Packing Unit	Packaging
62502	25 cm	250(150)×15×2	91	4 960910 625020	12	
62510	30 cm	300(180)×15×2	109	4 960910 625105	12	VH
62529	45 cm	450(300)×15×2	171	4 960910 625297	5	
62532	60 cm	600(400)×15×2	235	4 960910 625327	5	

Japanese Sliding Bevel

62596



● Parts are listed from p.231

Features

- Can be adjusted to any angle
- Sliding bevel can be fixed at any angle with screw stoppers

Use

- Scribing and drawing of any angle
- For scribing dovetail or ink scribing

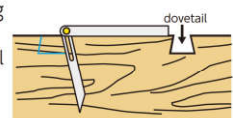

Specifications

Material	Body: Stainless steel	Screw: Brass
----------	-----------------------	--------------

Item Code	Description	Length×Width×Thickness (mm)	Weight (g)	JAN Code	Packing Unit	Packaging
62588	15 cm	180×14×5.5	111	4 960910 625884	12	VH
62596	25 cm	250×19×5.5	202	4 960910 625969	12	VH