

Serie/Series

06130

Frese ad angolo divergente
Dovetail cutters

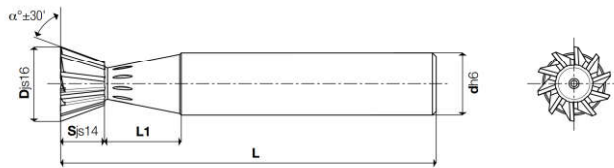

COATING Skin	W A RICHIESTA ON REQUEST	F A RICHIESTA ON REQUEST	N	UNI 8262A DIN 1833A ISO 3959	Z10±12
------------------------	--------------------------------	--------------------------------	---	------------------------------------	--------

Cod. Art.	M-TK (HSS-E)	X-85 (PM Co 8,5%)	COATED	Djs16	α° $\pm 30'$	Sjs14	L1	L	dh6	Z
061304516 AM	CM	CMX	16	45	4	11,3	60	12	10	
061304520 AM	CM	CMX	20	45	5	13,5	63	12	10	
061304525 AM	CM	CMX	25	45	6,3	13	67	12	10	
061304532 AM	CM	CMX	32	45	8	14	71	16	12	
061306016 AM	CM	CMX	16	60	6,3	11	60	12	10	
061306020 AM	CM	CMX	20	60	8	10	63	12	10	
061306025 AM	CM	CMX	25	60	10	11,5	67	12	10	
061306032 AM	CM	CMX	32	60	12,5	10	71	16	12	
061307016 AM	CM	CMX	16	70	7	10	60	12	10	
061307020 AM	CM	CMX	20	70	9	10	63	12	10	
061307025 AM	CM	CMX	25	70	11	8,7	67	16	10	



Serie/Series
06145

Frese ad angolo convergente
Inverted dovetail cutters

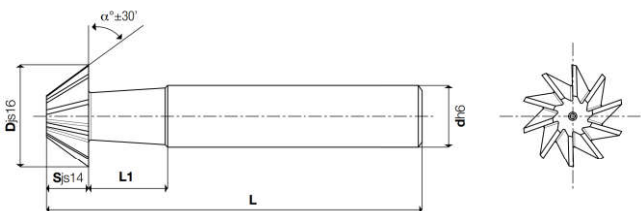

COATING Skin	W A RICHIESTA ON REQUEST	F A RICHIESTA ON REQUEST	N	UNI 8262B DIN 1833B ISO 3959	Z10±12
------------------------	--------------------------------	--------------------------------	---	------------------------------------	--------

Cod. Art.	M-TK (HSS-E)	X-85 (PM Co 8,5%)	COATED	Djs16	α° $\pm 30'$	Sjs14	L1	L	dh6	Z
061454516 AM	CM	CMX	16	45	4	11,3	60	12	10	
061454520 AM	CM	CMX	20	45	5	13,5	63	12	10	
061454525 AM	CM	CMX	25	45	6,3	13	67	12	10	
061454532 AM	CM	CMX	32	45	8	14	71	16	12	
061456016 AM	CM	CMX	16	60	6,3	11	60	12	10	
061456020 AM	CM	CMX	20	60	8	10	63	12	10	
061456025 AM	CM	CMX	25	60	10	11,5	67	12	10	
061456032 AM	CM	CMX	32	60	12,5	10	71	16	12	
061457016 AM	CM	CMX	16	70	7	10	60	12	10	
061457020 AM	CM	CMX	20	70	9	10	63	12	10	
061457025 AM	CM	CMX	25	70	11	8,7	67	16	10	



MATERIALI LAVORABILI / WORKPIECE MATERIALS

serie	TITANIO TITANIUM	HRSA HRSA	ACCIAI INOSSIDABILI STAINLESS STEELS	MATERIALI NON FERROSI NON FERROUS MATERIALS	LEGHE LEGGERE LIGHT ALLOYS	ACCIAI STEELS	GHISE CAST IRON
06130	●	●	●	○	○	●	●
06145	●	●	●	○	○	●	●

● consigliata/recommended ● accettabile/acceptable ○ non consigliata/not recommended