

Serie/Series 06130

Frese ad angolo divergente
Dovetail cutters

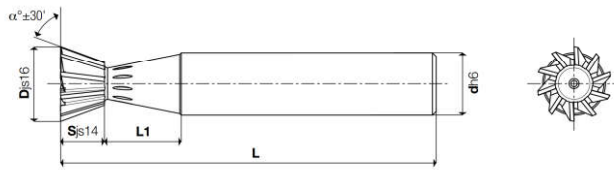

COATING Skin	W A RICHIESTA ON REQUEST	F A RICHIESTA ON REQUEST	N	UNI 8262A DIN 1833A ISO 3959	Z10±12
------------------------	--------------------------------	--------------------------------	---	------------------------------------	--------

Cod. Art.	M-TK (HSS-E)	X-85 (PM Co 8,5%)	COATED	Djs16	α° $\pm 30'$	Sjs14	L1	L	dh6	Z
061304516 AM	AM	CM	CMX	16	45	4	11,3	60	12	10
061304520 AM	AM	CM	CMX	20	45	5	13,5	63	12	10
061304525 AM	AM	CM	CMX	25	45	6,3	13	67	12	10
061304532 AM	AM	CM	CMX	32	45	8	14	71	16	12
061306016 AM	AM	CM	CMX	16	60	6,3	11	60	12	10
061306020 AM	AM	CM	CMX	20	60	8	10	63	12	10
061306025 AM	AM	CM	CMX	25	60	10	11,5	67	12	10
061306032 AM	AM	CM	CMX	32	60	12,5	10	71	16	12
061307016 AM	AM	CM	CMX	16	70	7	10	60	12	10
061307020 AM	AM	CM	CMX	20	70	9	10	63	12	10
061307025 AM	AM	CM	CMX	25	70	11	8,7	67	16	10



Serie/Series

06145

Frese ad angolo convergente
Inverted dovetail cutters

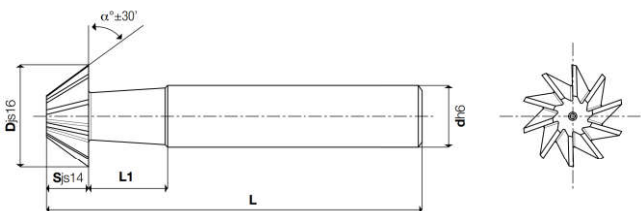

COATING Skin	W A RICHIESTA ON REQUEST	F A RICHIESTA ON REQUEST	N	UNI 8262B DIN 1833B ISO 3959	Z10±12
------------------------	--------------------------------	--------------------------------	---	------------------------------------	--------

Cod. Art.	M-TK (HSS-E)	X-85 (PM Co 8,5%)	COATED	Djs16	α° $\pm 30'$	Sjs14	L1	L	dh6	Z
061454516 AM	AM	CM	CMX	16	45	4	11,3	60	12	10
061454520 AM	AM	CM	CMX	20	45	5	13,5	63	12	10
061454525 AM	AM	CM	CMX	25	45	6,3	13	67	12	10
061454532 AM	AM	CM	CMX	32	45	8	14	71	16	12
061456016 AM	AM	CM	CMX	16	60	6,3	11	60	12	10
061456020 AM	AM	CM	CMX	20	60	8	10	63	12	10
061456025 AM	AM	CM	CMX	25	60	10	11,5	67	12	10
061456032 AM	AM	CM	CMX	32	60	12,5	10	71	16	12
061457016 AM	AM	CM	CMX	16	70	7	10	60	12	10
061457020 AM	AM	CM	CMX	20	70	9	10	63	12	10
061457025 AM	AM	CM	CMX	25	70	11	8,7	67	16	10



MATERIALI LAVORABILI / WORKPIECE MATERIALS

serie	TITANIO TITANIUM	HRSA HRSA	ACCIAI INOSSIDABILI STAINLESS STEELS	MATERIALI NON FERROSI NON FERROUS MATERIALS	LEGHE LEGGERE LIGHT ALLOYS	ACCIAI STEELS	GHISE CAST IRON
06130	●	●	●	○	○	●	●
06145	●	●	●	○	○	●	●

● consigliata/recommended ● accettabile/acceptable ○ non consigliata/not recommended