

Serie/Series

27150

Frese per scanalature a T
T-slot cutters

27155

Frese per scanalature a T
T-slot cutters

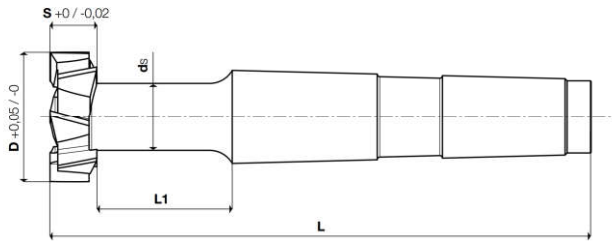

COATING

Skin

N

UNI 7339B
DIN 851B
ISO 3337

Cod. Art.	M-TK (HSS-E)	X-85 (PM Co 8,5%)	COATED	D +0,05 -0	S +0 -0,02	ds	L1	L	MORSE TAPER	λ°	Z
271501256 AM	CM	CMX	CMX	12,5	6	5	9	72	1	12	8
271501608 AM	CM	CMX	CMX	16	8	7	12	77	1	12	8
271501808 AM	CM	CMX	CMX	18	8	8	17	82	1	15	8
271501909 AM	CM	CMX	CMX	19	9	8	16	82	1	15	8
271502109 AM	CM	CMX	CMX	21	9	10	24	102	2	15	8
271502210 AM	CM	CMX	CMX	22	10	10	23	102	2	15	8
271502511 AM	CM	CMX	CMX	25	11	12	24	104	2	15	8
271502812 AM	CM	CMX	CMX	28	12	13	25	106	2	15	8
271503214 AM	CM	CMX	CMX	32	14	15	28	111	2	15	8
271503616 AM	CM	CMX	CMX	36	16	17	31	133	3	15	8
271504018 AM	CM	CMX	CMX	40	18	19	36	140	3	15	8
271504520 AM	CM	CMX	CMX	45	20	20	37	143	3	15	8
271505022 AM	CM	CMX	CMX	50	22	25	46	177	4	10	10
271505624 AM	CM	CMX	CMX	56	24	27	49	182	4	10	10

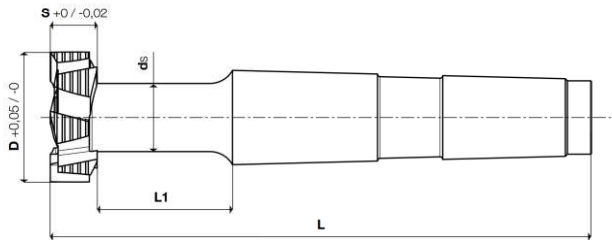
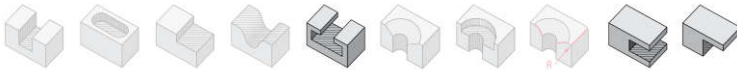

COATING

Skin

NF

UNI 7339B
DIN 851B
ISO 3337

Cod. Art.	M-TK (HSS-E)	X-85 (PM Co 8,5%)	COATED	D +0,05 -0	S +0 -0,02	ds	L1	L	MORSE TAPER	Z
271551256 AM	CM	CMX	CMX	12,5	6	5	9	72	1	4
271551608 AM	CM	CMX	CMX	16	8	7	12	77	1	6
271551808 AM	CM	CMX	CMX	18	8	8	17	82	1	6
271551909 AM	CM	CMX	CMX	19	9	8	16	82	1	6
271552109 AM	CM	CMX	CMX	21	9	10	24	102	2	6
271552210 AM	CM	CMX	CMX	22	10	10	23	102	2	6
271552511 AM	CM	CMX	CMX	25	11	12	24	104	2	8
271552812 AM	CM	CMX	CMX	28	12	13	25	106	2	8
271553214 AM	CM	CMX	CMX	32	14	15	28	111	2	8
271553616 AM	CM	CMX	CMX	36	16	17	31	133	3	8
271554018 AM	CM	CMX	CMX	40	18	19	36	140	3	8
271554520 AM	CM	CMX	CMX	45	20	20	37	143	3	8
271555022 AM	CM	CMX	CMX	50	22	25	46	177	4	8
271555624 AM	CM	CMX	CMX	56	24	27	49	182	4	8

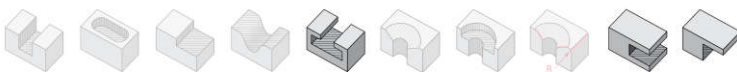

Z8÷10 Z4÷8



MATERIALI LAVORABILI / WORKPIECE MATERIALS

serie séries	TITANIO TITANIUM	HRSA HRSA	ACCIAI INOSSIDABILI STAINLESS STEELS	MATERIALI NON FERROSI NON FERROUS MATERIALS	LEGHE LEGGERE LIGHT ALLOYS	ACCIAI STEELS	GHISE CAST IRON
27150	●	●	●	○	○	●	●
27155	●	●	●	○	○	●	●

● consigliata/recommended ● accettabile/acceptable ○ non consigliata/not recommended