

HSS-PM HSS-PM Line

Serie/Series

27505

Frese coniche a svasare
Countersinks



Z5÷11

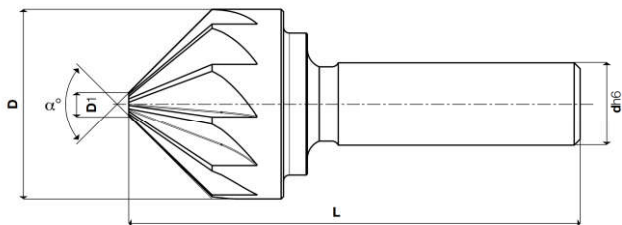

COATING

Skin

N

UNI 6847
DIN
334-335
ISO

Cod. Art.	M-TK (HSS-E)	COATED	D	D1	α°	L	dh6	Z
275051060 AM	AMX	AMX	6,3	1,6	60	45	5	5
275051080 AM	AMX	AMX	8,4	2	60	50	6	5
275051120 AM	AMX	AMX	12,5	2	60	50	8	5
275051160 AM	AMX	AMX	16	3,2	60	60	10	7
275051200 AM	AMX	AMX	20	5	60	63	10	7
275051250 AM	AMX	AMX	25	5	60	72	10	9
275051300 AM	AMX	AMX	30	7	60	80	12	9
275051350 AM	AMX	AMX	35	7	60	85	12	9
275051500 AM	AMX	AMX	50	10	60	100	16	11
275052060 AM	AMX	AMX	6,3	1,6	90	45	5	5
275052080 AM	AMX	AMX	8,4	2	90	50	6	5
275052120 AM	AMX	AMX	12,5	2	90	48	8	5
275052160 AM	AMX	AMX	16	3,2	90	56	10	7
275052200 AM	AMX	AMX	20	5	90	60	10	7
275052250 AM	AMX	AMX	25	5	90	70	10	9
275052300 AM	AMX	AMX	30	7	90	78	12	9
275052450 AM	AMX	AMX	45	9	90	92	16	11



Serie/Series 27505

Frese coniche a svasare
Countersinks



Z1

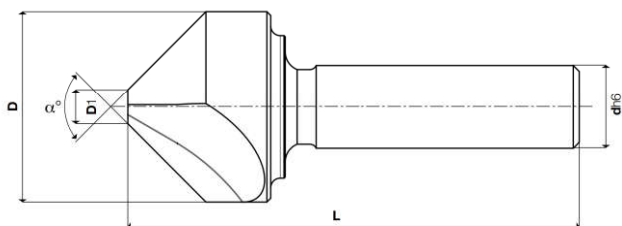

COATING

Skin

N

UNI 6847
DIN
334-335
ISO

Cod. Art.	M-TK (HSS-E)	COATED	D	D1	α°	L	dh6	Z
275051061 AM	AMX	AMX	6,3	1,6	60	45	5	1
275051081 AM	AMX	AMX	8,1	2	60	50	6	1
275051121 AM	AMX	AMX	12,5	2	60	50	8	1
275051161 AM	AMX	AMX	16	3,2	60	60	10	1
275051201 AM	AMX	AMX	20	5	60	63	10	1
275051251 AM	AMX	AMX	25	5	60	72	10	1
275051301 AM	AMX	AMX	30	7	60	80	12	1
275051351 AM	AMX	AMX	35	7	60	85	12	1
275051501 AM	AMX	AMX	50	10	60	100	16	1
275052061 AM	AMX	AMX	6,3	1,6	90	45	5	1
275052081 AM	AMX	AMX	8,4	2	90	50	6	1
275052121 AM	AMX	AMX	12,5	2	90	48	8	1
275052161 AM	AMX	AMX	16	3,2	90	56	10	1
275052201 AM	AMX	AMX	20	5	90	60	10	1
275052251 AM	AMX	AMX	25	5	90	70	10	1
275052301 AM	AMX	AMX	30	7	90	78	12	1
275052451 AM	AMX	AMX	45	9	90	92	16	1



MATERIALI LAVORABILI / WORKPIECE MATERIALS

serie	TITANIO TITANIUM	HRSA HRSA	ACCIAI INOSSIDABILI STAINLESS STEELS	MATERIALI NON FERROSI NON FERROUS MATERIALS	LEGHE LEGGERE LIGHT ALLOYS	ACCIAI STEELS	GHISE CAST IRON
27505	●	●	●	○	○	●	●
27505	●	●	●	○	○	●	●

● consigliata/recommended ○ accettabile/acceptable ○ non consigliata/not recommended