

HSS-PM HSS-PM Line

Serie/Series

29110

Frese a profilo costante convesso
Form relieved convex milling cutters

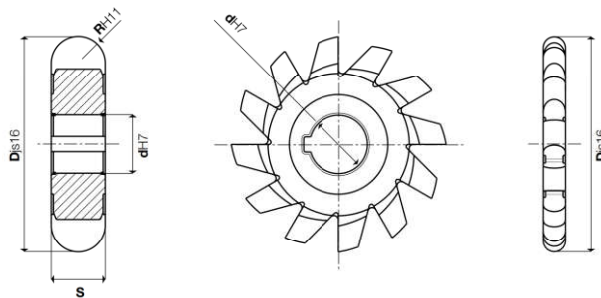

COATING

Skin

N

UNI 4498
DIN 856
ISO

Z12÷14



Cod. Art.	M-TK (HSS-E)	COATED	RH11	Djs16	S	dH7	Z
291100100 AM	AMX	AMX	1	50	2	22	14
291100150 AM	AMX	AMX	1,5	50	3	22	14
291100200 AM	AMX	AMX	2	50	4	22	14
291100250 AM	AMX	AMX	2,5	56	5	22	14
291100300 AM	AMX	AMX	3	56	6	22	14
291100350 AM	AMX	AMX	3,5	63	7	22	14
291100400 AM	AMX	AMX	4	63	8	22	14
291100450 AM	AMX	AMX	4,5	63	9	22	14
291100500 AM	AMX	AMX	5	63	10	22	14
291100550 AM	AMX	AMX	5,5	70	11	22	14
291100600 AM	AMX	AMX	6	70	12	22	14
291100650 AM	AMX	AMX	6,5	70	13	22	14
291100700 AM	AMX	AMX	7	70	14	22	14
291100750 AM	AMX	AMX	7,5	70	15	22	12
291100800 AM	AMX	AMX	8	70	16	22	12
291100850 AM	AMX	AMX	8,5	90	17	27	12
291100900 AM	AMX	AMX	9	90	18	27	12
291100950 AM	AMX	AMX	9,5	90	19	27	12
291101000 AM	AMX	AMX	10	90	20	27	12
291101100 AM	AMX	AMX	11	90	22	27	12
291101200 AM	AMX	AMX	12	90	24	27	12
291101250 AM	AMX	AMX	12,5	100	25	27	12
291101300 AM	AMX	AMX	13	100	26	27	12
291101400 AM	AMX	AMX	14	100	28	27	12
291101500 AM	AMX	AMX	15	110	30	32	12
291101600 AM	AMX	AMX	16	110	32	32	12
291101700 AM	AMX	AMX	17	110	34	32	12
291101800 AM	AMX	AMX	18	110	36	32	12
291101900 AM	AMX	AMX	19	125	38	32	12
291102000 AM	AMX	AMX	20	125	40	32	12



MATERIALI LAVORABILI / WORKPIECE MATERIALS

