

Specification

Model No.	PRLR-75	
Dimensions	Length	260mm
	Width	168mm
	Height	211mm
Weight	Approx. 11kg	

CHARACTERISTICS

Nominal Voltage	12.8V
Nominal Capacity	75Ah
Nominal Energy	960Wh
Internal Impedance	≤15mΩ
Charge Voltage	14.4V
Discharge Cut-off Voltage	8V
Charge Current	15A
Max. Charge Current	75A
Standard Discharge Current	37.5A
Max. Continuous Discharge	75A
Peak Discharge Current	150A<5S
Operating Temperature	Charge 0°C ~ +45°C
	Discharge -20°C ~ +55°C

Note: Maximum 4 batteries in series (total voltage 12V-48V)

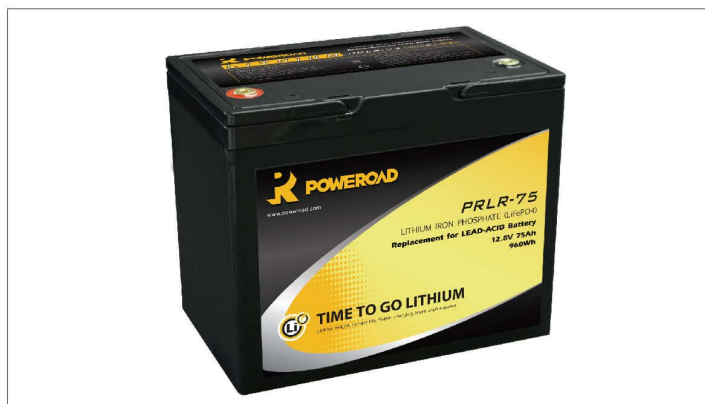

PRLR-75

DRAWINGS

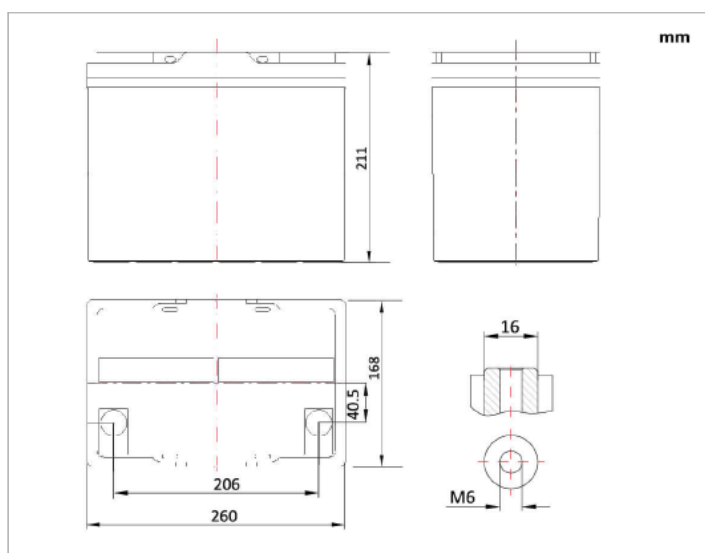

DISCHARGING GRAPH

Charge Characteristic Curve

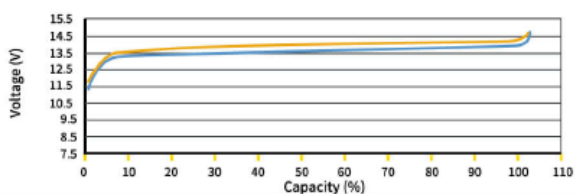

Discharge Characteristic Curve

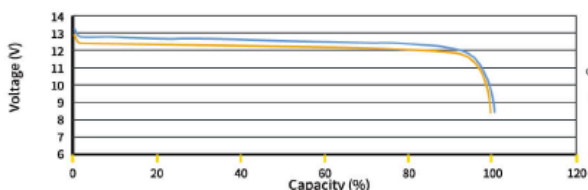

Temperature vs. Capacity

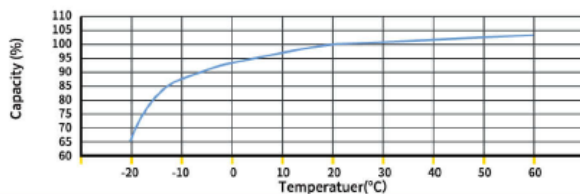

Cycle Life Curve @1C

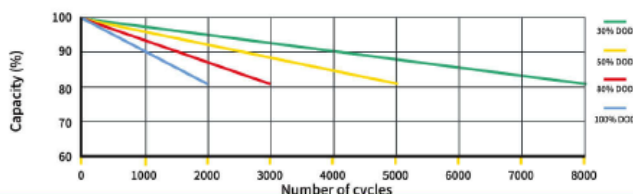

CERTIFICATIONS

UN38.3 CE

Address: DC Power House, 25 Earlstrees Road,
Earlstrees Industrial Estate, Corby, England, NN17 4AZ

**For any information or prices please
contact the team today on:**

T.01536 464890
E.sales@dcbattery.tech
W.www.dcbattery.tech